

11 July 2023 at 7.00 pm

Council Chamber, Argyle Road, Sevenoaks

Published: 13.07.23



Development & Conservation Advisory Committee

Supplementary Agenda

	Pages
9. Conservation Area Appraisal Updates Presentation	(Pages 1 - 8)

If you wish to obtain further factual information on any of the agenda items listed above, please contact the named officer prior to the day of the meeting.

Should you need this agenda or any of the reports in a different format, or have any other queries concerning this agenda or the meeting please contact Democratic Services on 01732 227000 or democratic.services@sevenoaks.gov.uk.

This page is intentionally left blank

DCAC

Conservation Area Appraisals Updates

11 July 2023

Introduction

- National legislation
- Rolling programme of review
- 41 conservation areas
- Current project has reviewed:
 - Eynsford Conservation Area
 - Farningham Conservation Area
 - Kemsing Conservation Area

Page 2



Agenda Item 9

The Process

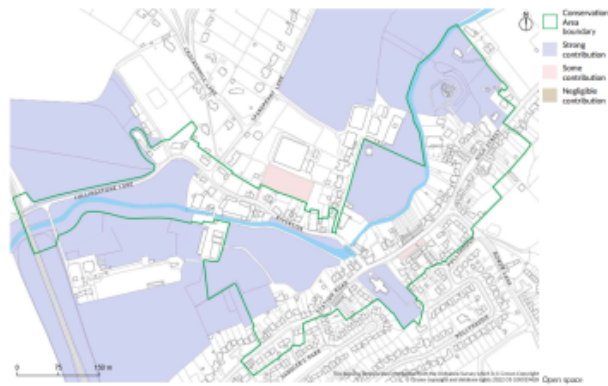
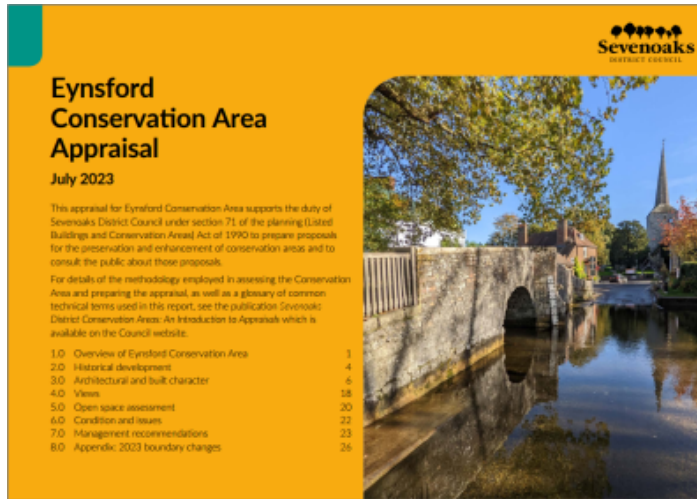

Eynsford Conservation Area Appraisal July 2023

- Revised format that includes:
 - Open Space Assessment
 - Views
 - Management Recommendations
- Public engagement

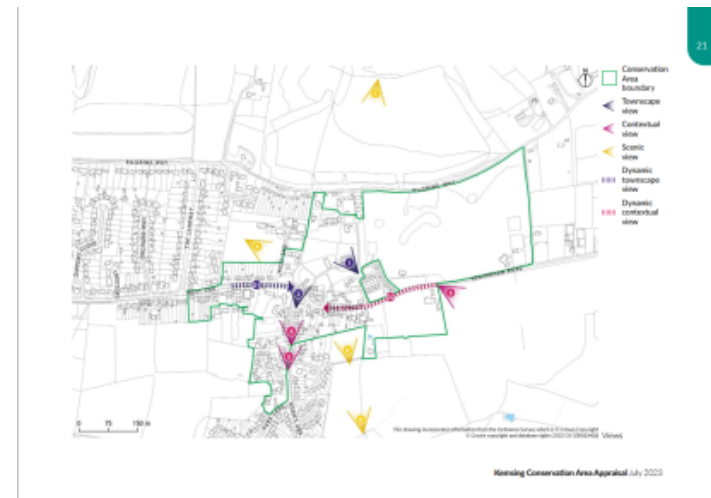

Horsham Conservation Area Appraisal July 2023

Eynsford Conservation Area

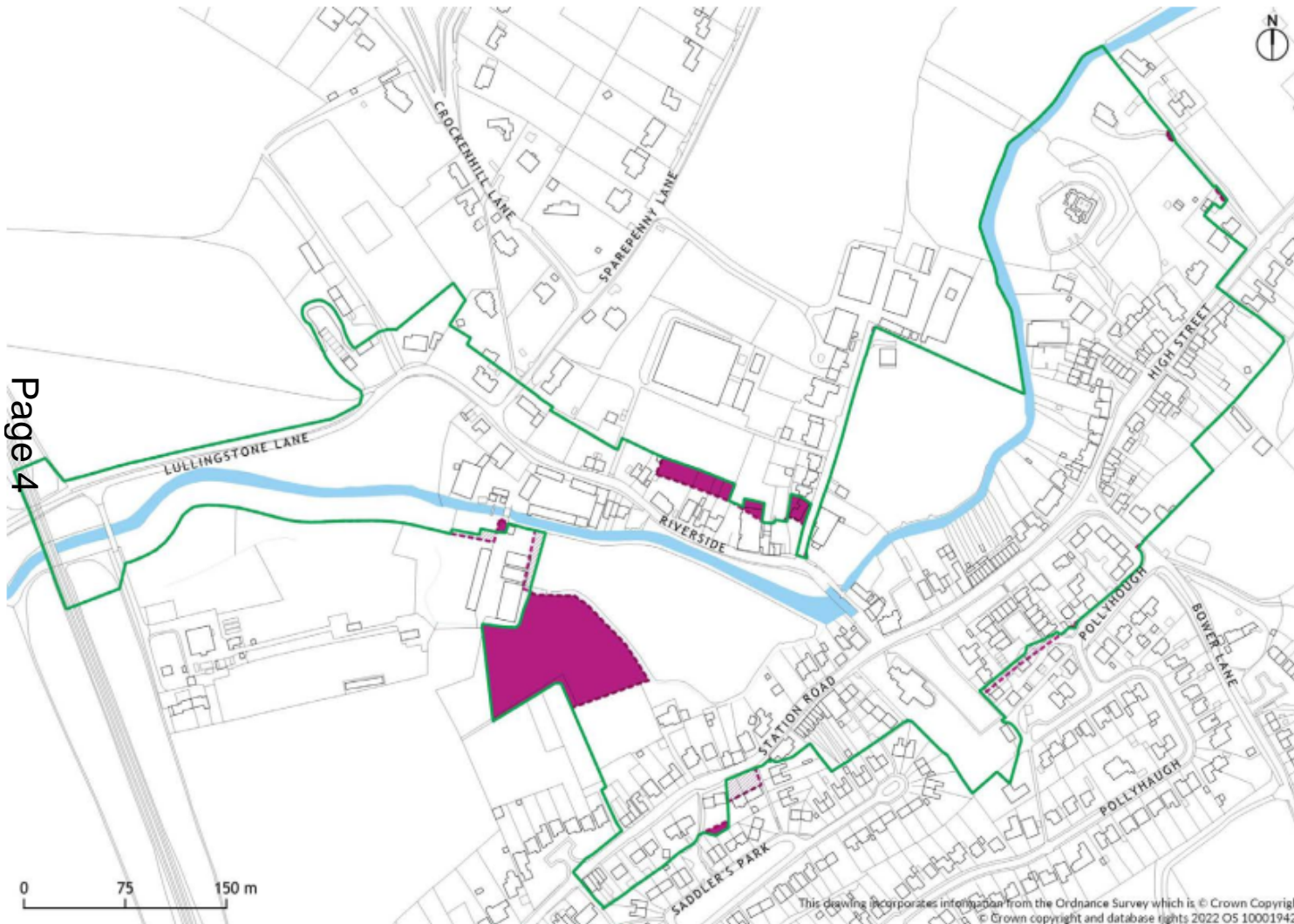



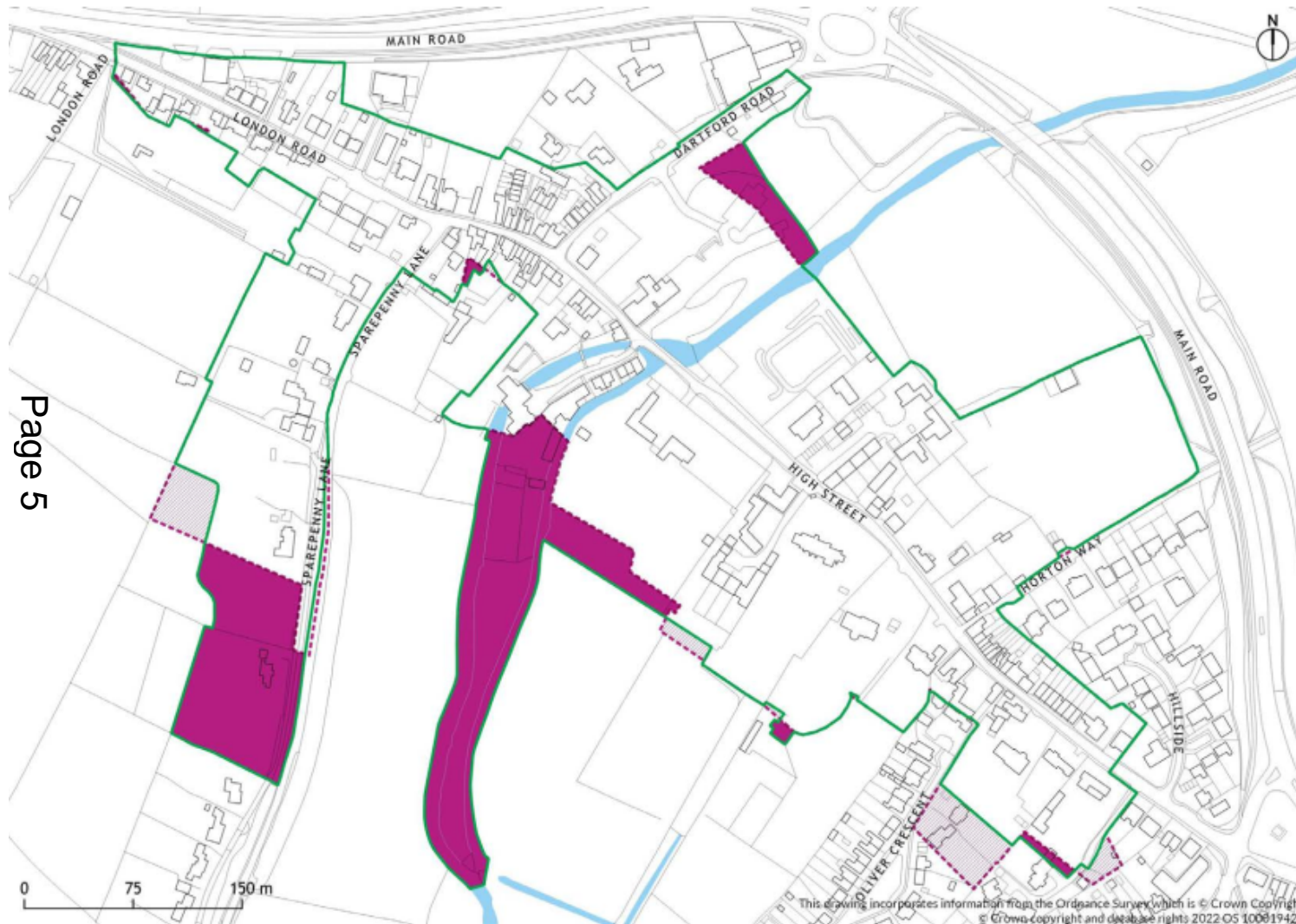

The Conservation Area was first designated in 1973 and extended in 2006. This map shows the boundary as adopted in 2006 with amendments made following review in 2023.

This drawing incorporates information from the Ordnance Survey which is © Crown Copyright © Crown copyright and database rights 2022 OS 100019428

Farningham Conservation Area



-  Revised Conservation Area boundary
-  Previous Conservation Area boundary
-  Additions
-  Removals

The Conservation Area was first designated in 1969 and the boundaries were subsequently extended in 1990 and 2006. This map shows the boundary as adopted in 2006 with amendments made following review in 2023.

This drawing incorporates information from the Ordnance Survey which is © Crown Copyright
© Crown copyright and database rights 2022 OS 100019428

Kemsing Conservation Area

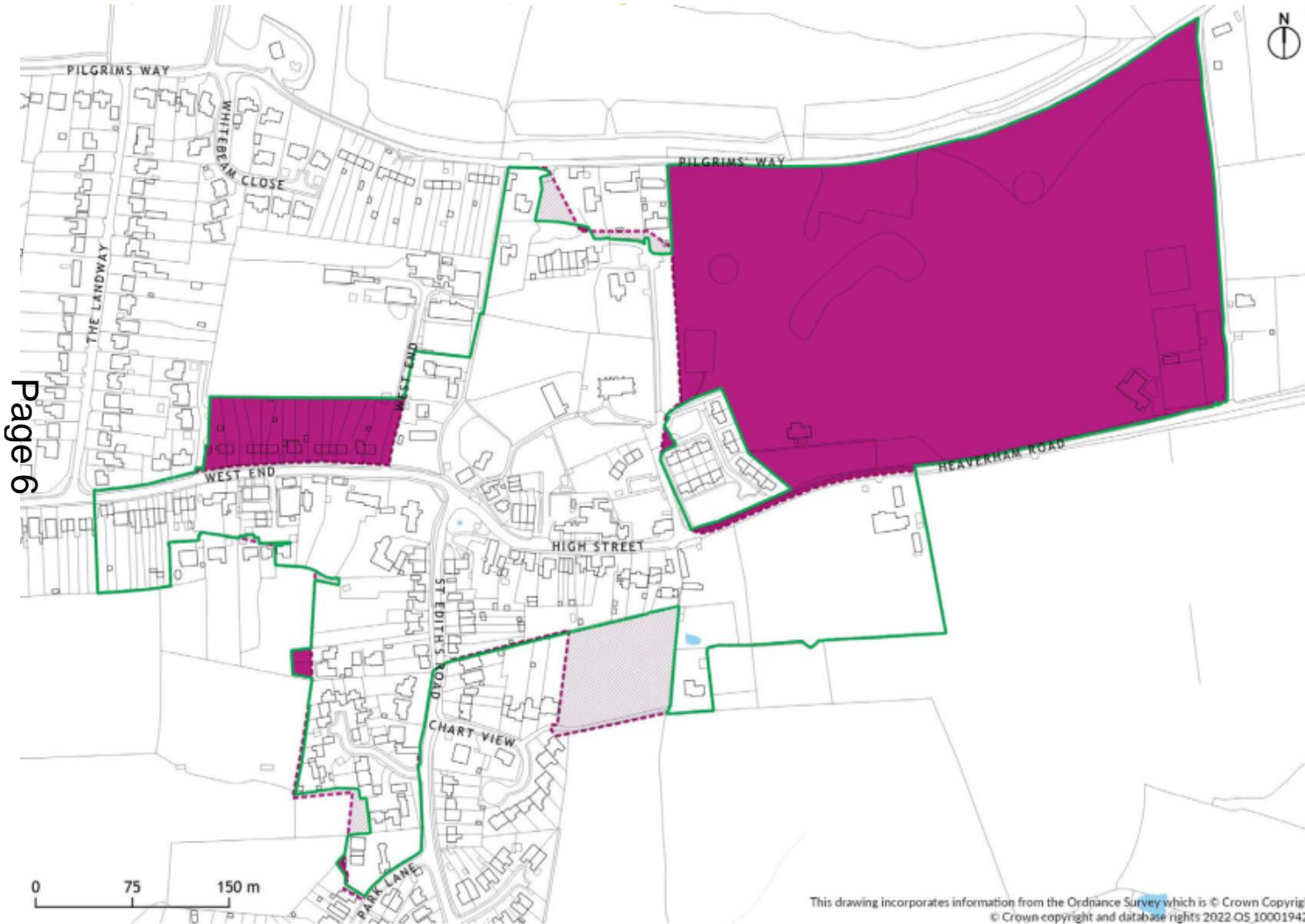

- Revised Conservation Area boundary
- Previous Conservation Area boundary
- Additions
- Removals

The Conservation Area was first designated in 1972 and subsequently extended in 1990 and 2006. This map shows the boundary as adopted in 2006 with amendments made following review in 2023

This drawing incorporates information from the Ordnance Survey which is © Crown Copyright © Crown copyright and database rights 2022 OS 100019428

Kemsing Conservation Area

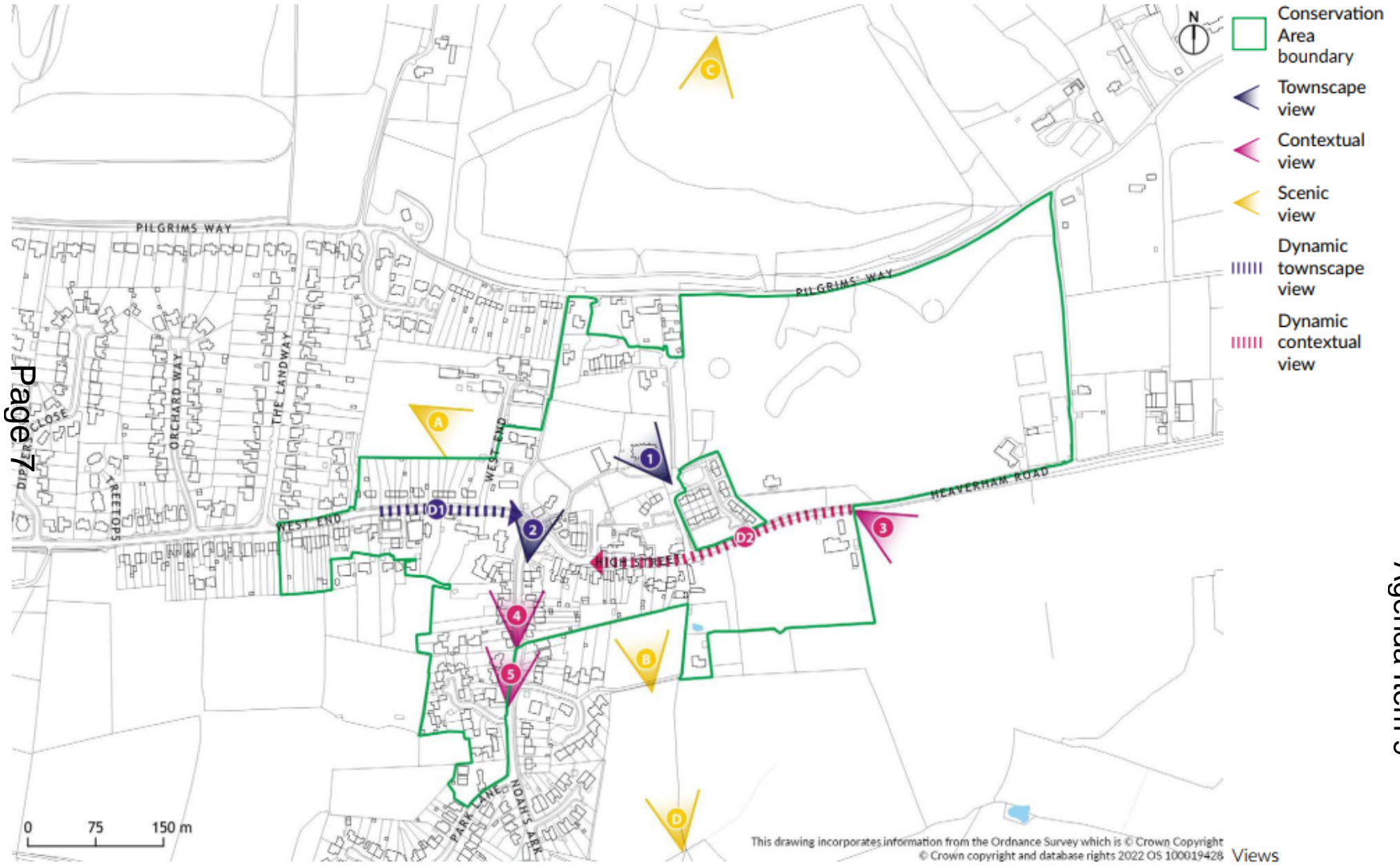

This page is intentionally left blank