

17 July 2017 at 7.00 pm

Conference Room, Argyle Road, Sevenoaks



## Economic & Community Development Advisory Committee

At the above stated meeting the attached presentations were tabled for the following items

7. **Presentation on the importance of development to the local economy** (Pages 1 - 74)  
Guest speaker, Richard Reid (of Richard Reid and Associates (architects and master planners)) .
9. **Sevenoaks District Community Safety Strategy & Action Plan 2017-18** (Pages 75 - 92)
11. **Economic Development Strategy Monitoring Report** (Pages 93 - 94)

This page is intentionally left blank

# BUILDING THE WALKABLE AND HEALTHY CITY

## THE VIEW FROM THE STREET: RESTRUCTURING THE ORDINARY

Physical inactivity is a growing epidemic that is threatening the social and economic prosperity of communities around the world. The World Health Organisation identifies it as the fourth leading cause of global mortality. *Designed to Move*, a report by Nike, The American College of Sports Medicine and the International Council of Sports Science and Physical Education, details how movement has been engineered out of daily life, leaving today's children to face a shorter life expectancy than their parents. Levels of activity in the US and UK have fallen in by over 30% over two generations. In China, physical activity has fallen by 45% in just half a generation. The burgeoning health care costs, as more deaths are attributed to our physical inactivity than smoking, are enormous. It is estimated that the economic impact of physical inactivity cost the USA \$157 billion in 2008. *Designed to Move* is an urgent call for action and outlines recommendations for governments, civic societies, corporations and individuals, amongst others, on how they can contribute to the solution.



SEVENOAKS DISTRICT COUNCIL

ECONOMIC AND COMMUNITY DEVELOPMENT ADVISORY COMMITTEE

17-07-17



Page 2

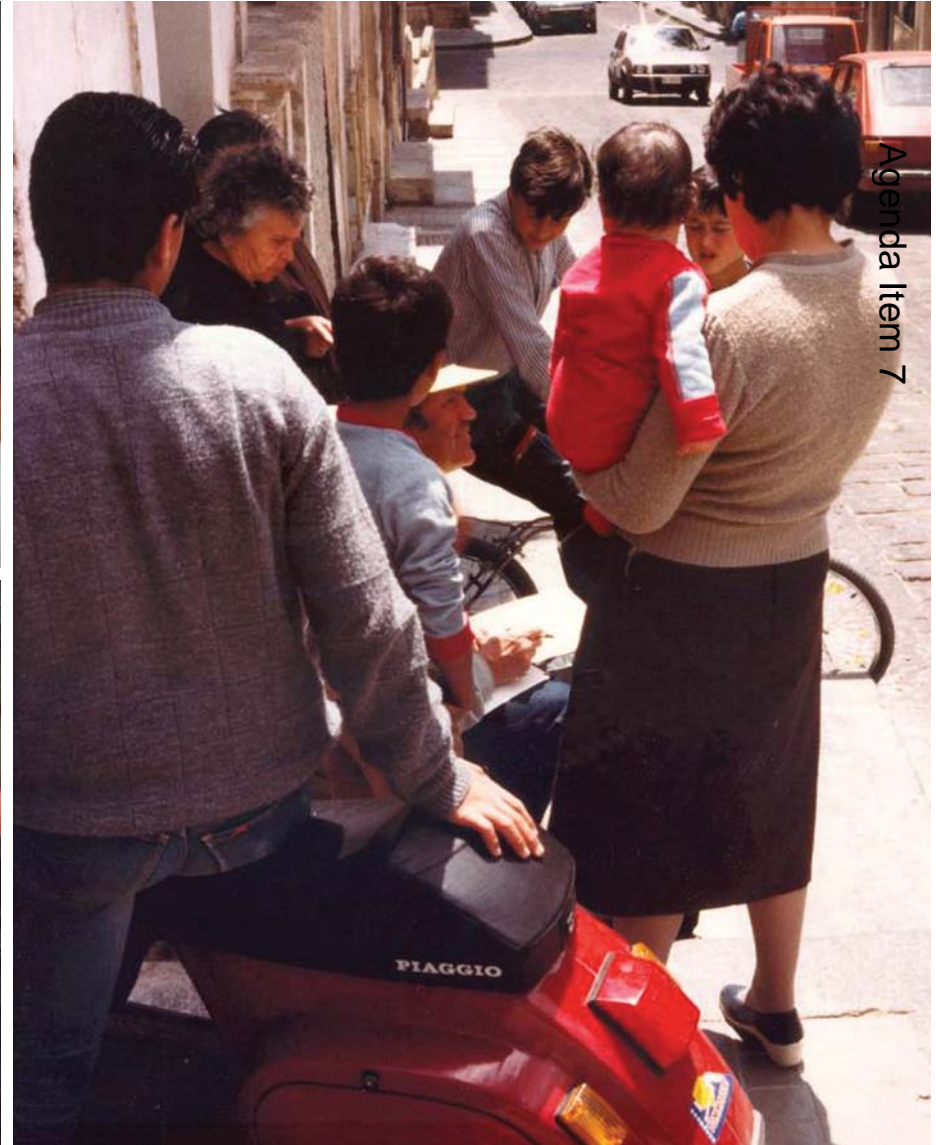

Agenda Item 7



Page 3

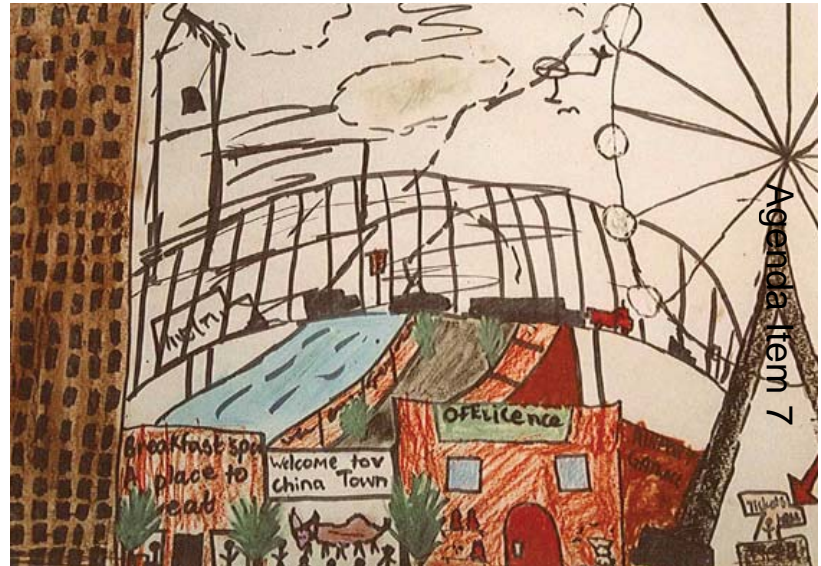
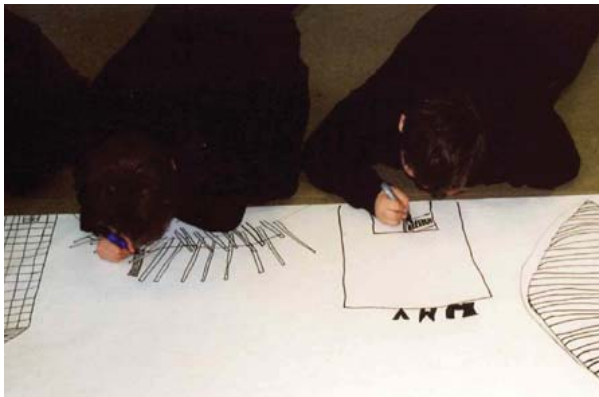
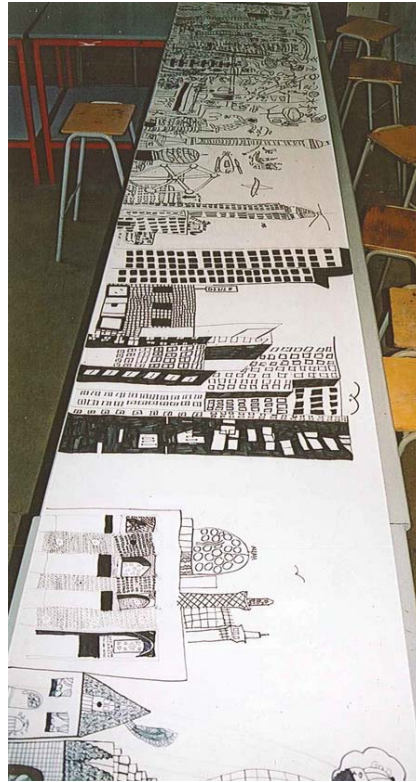

Agenda Item 7

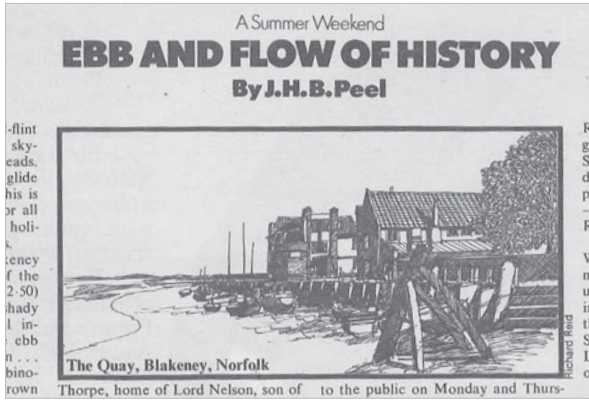

Weekend Telegraph

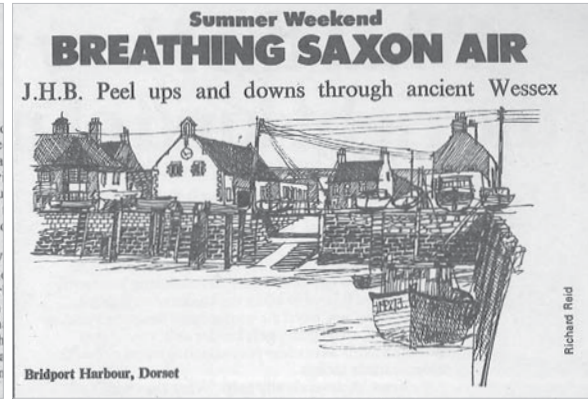

Weekend Telegraph



House and Garden



Fort Times



Journey to the Orient (sketchbooks)



Journey to the Orient (sketchbooks)

Page 5



Ford Times

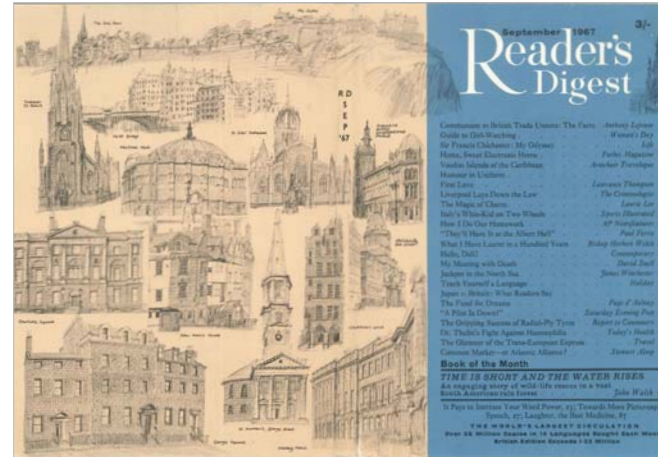

Reader's Digest

Agenda Item 7



Weekend Telegraph

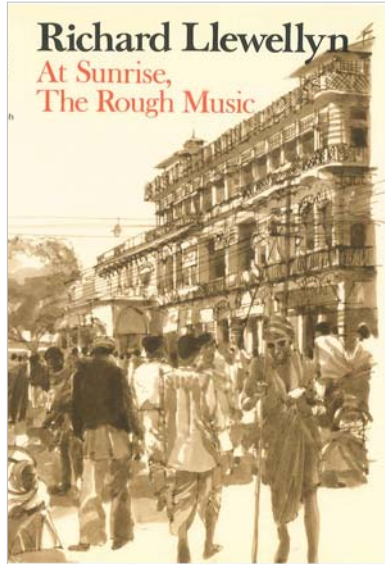

Michael Joseph

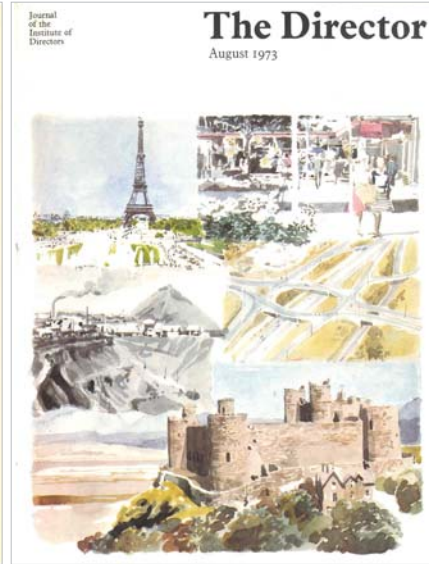

The Director



Michael Joseph

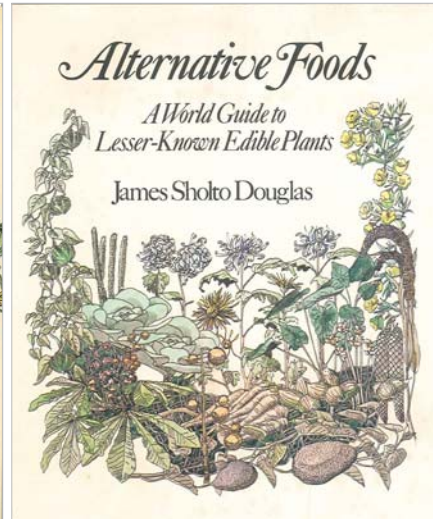

Pelham Books

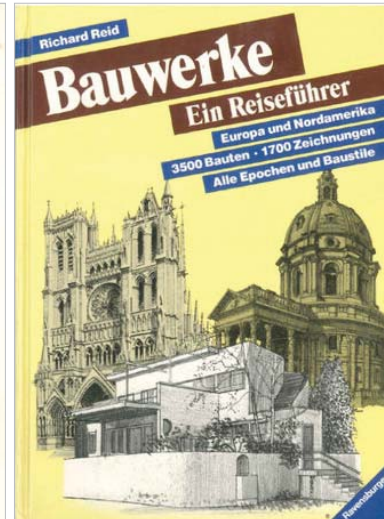

Bauwerke



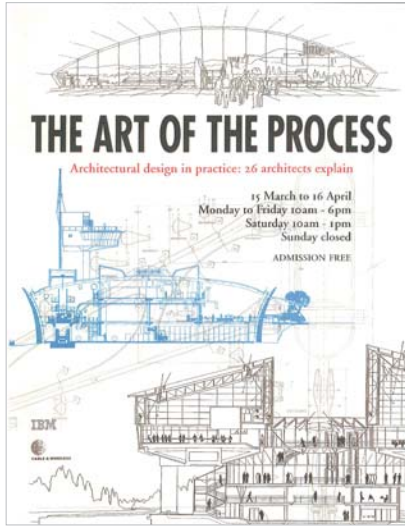

RIBA Exhibition

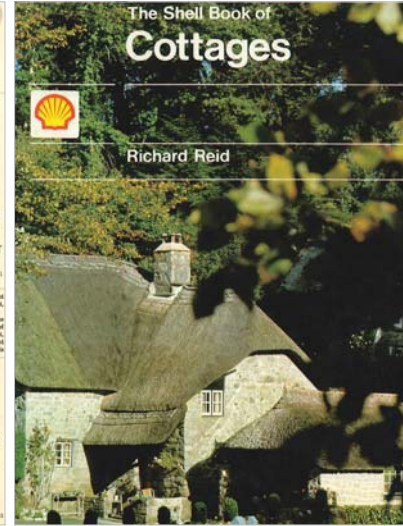
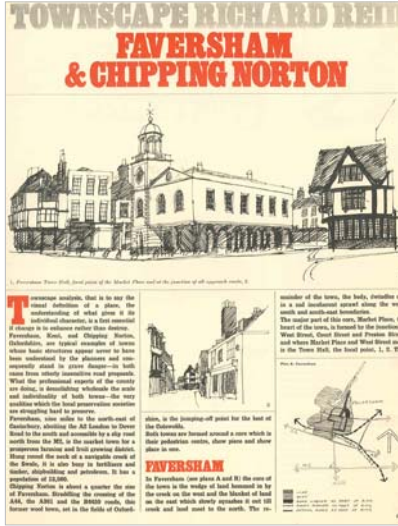

Michael Joseph

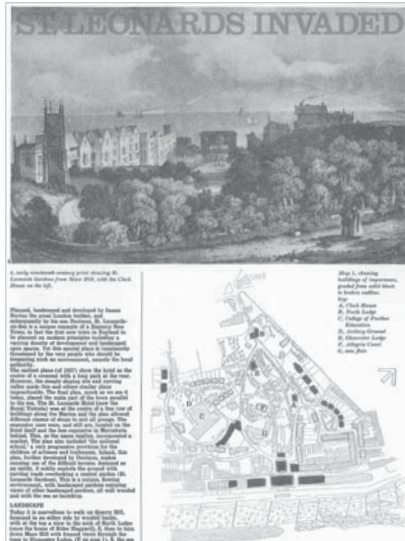

The Architectural Review

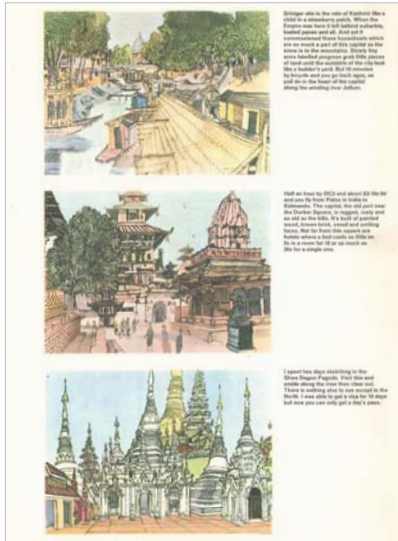

RIBA Journal



The Architectural Review



Lower Mill Estate



Epping Forest Civic Offices

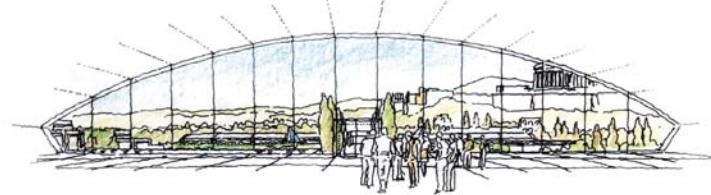

New Museum of the Acropolis, Athens



Epping Forest Civic Offices



Epping Forest Civic Offices



Epping Forest Civic Offices



Epping Forest Civic Offices

EPPING FOREST CIVIC OFFICE Epping Forest

Won in an architectural competition, the building with a brick tower, two storey high entrance 'porch' with a great fore-stair and curving council chamber and public gallery projecting out from the ordered brick main facade, is a fragment of townscape of which the town Epping Forest abounds. The tower, which gives the building a civic quality and focal point, is one of a pair flanking the central church tower located at the centre of the High Street. The project was given an RIBA Award.

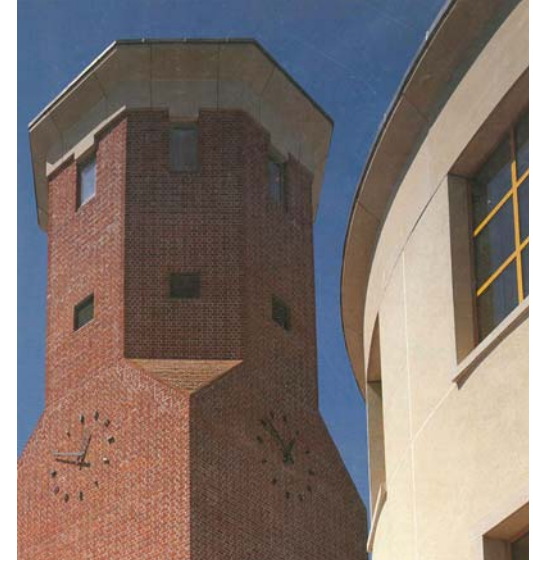
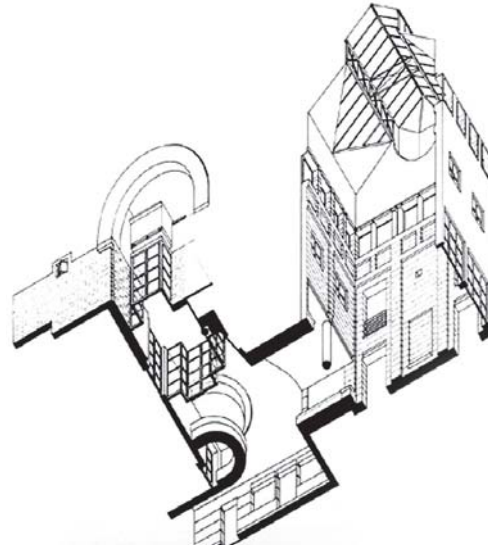

Agenda Item 7



Page 10



Agenda Item 7

KLEINZSCHUCHER Leipzig

The Masterplan of the 60-hectare garden district of Kleinzschocher, ten minutes by train from the city centre, was won in an international Urban Design Competition organised by the City of Leipzig.

The commission was to prepare a detailed evaluation of the existing building fabric and propose a strategy for improvement and enhancement for the future. In consultation with local community groups, business forums and the local city authorities, Richard Reid & Associates carried out the project in collaboration with the local engineering practice Kuhn Projektentwicklung GmbH.

A series of Planning for Real exercises were used to develop a comprehensive image map of the area based on the pioneering work of Kevin Lynch (image of the City). We then evolved a plan of strategic points or nodes in the district in order to create a framework around which to develop a series of benign fragments of varied scale and design to be developed by other hands through competitions. These evolving and changing elements, making the most of opportunities presented, were set within a stable framework of existing fabric with proposals for restoration and enhancement.

KLEINZSCHUCHER 德国莱比锡

德国莱比锡的莱比锡花园新区位于市中心仅需十分钟的火车车程。该新区赢得了由莱比锡市政府组织的国际城市设计竞赛。

该新区的设计目标是评估现有建筑肌理并进行详细的评价。在咨询当地社区团体、商业论坛以及当地城市当局后，理查德·里德与 Associates 与当地工程咨询公司 Kuhn Projektentwicklung GmbH 合作，共同完成该新区设计。

该新区的设计采用了“现实规划”的理念。一种规划设计理念，即通过制定战略节点或节点，在新区内制定出一个稳定的框架，围绕该框架开发一系列不同尺度和设计风格的良性建筑片段。这些不断演化和变化的元素，最大限度地利用了现有肌理中提供的机会，提出了修复和增强建议。

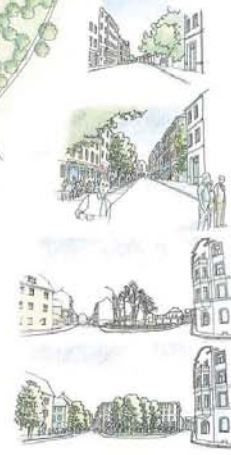
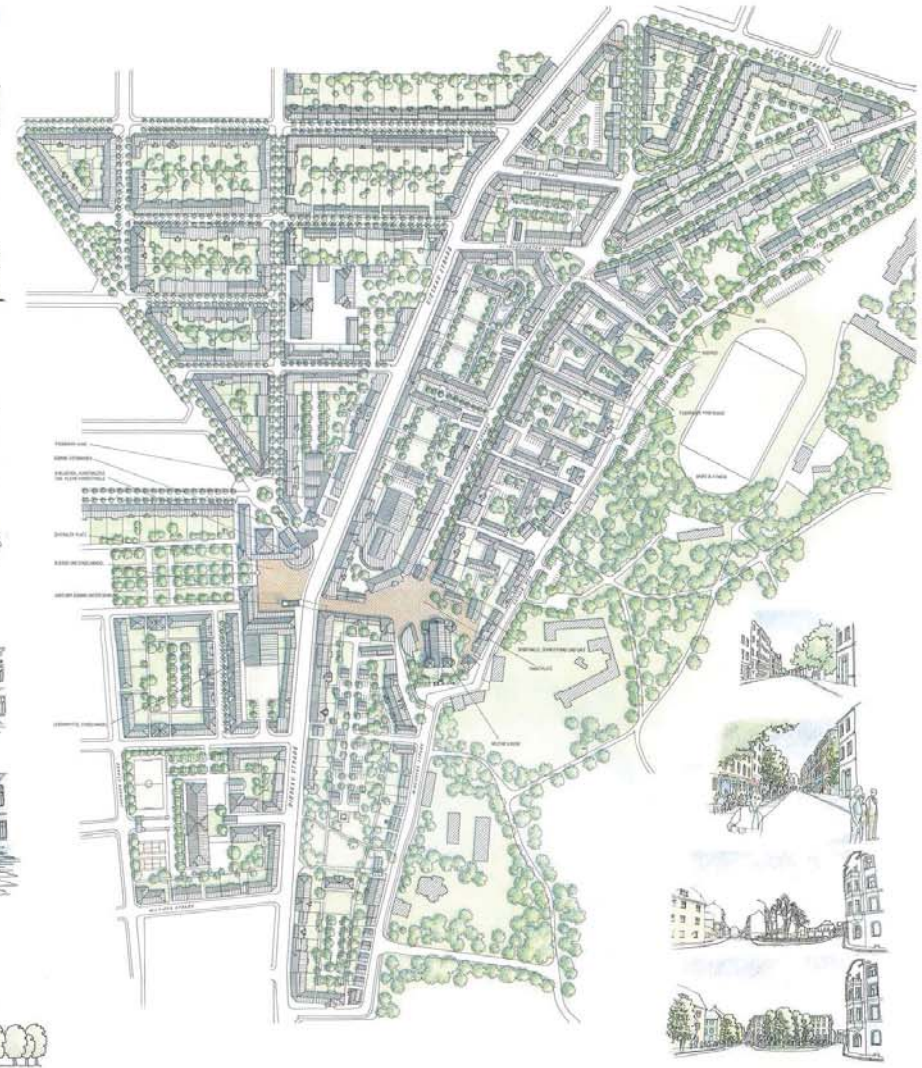
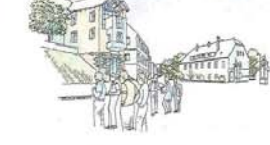
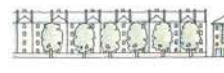

Page 11

Agenda Item 7

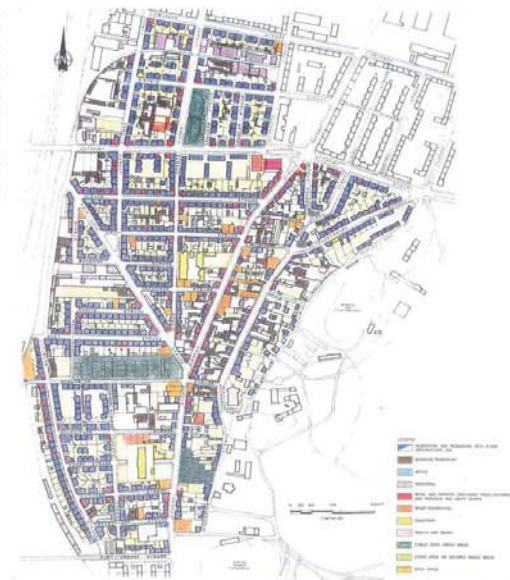

BERTALIA-LAZZARETTO,  
Bologna, Italy

The Masterplan, urban and architectural design for this site was won in an international architectural competition in 2001.

It is an 80-hectare site on the northwest edge of Bologna. Richard Reid & Associates, who developed the Masterplan and urban design for the project, are part of a team including Piero Sartogo of Sartogo Architeti Associati, Richard Meier and Partners and Studio Arco. The client is the City of Bologna and the University of Bologna.

The brief was to create a new district on the edge of the City of Bologna to accommodate an extension of the University. The design provides for a faculty of 7,000 staff and students, with accommodation for 1,000 students, 1,200 residential units and related educational, commercial and retail uses.

The urban design addressed the nature and form of Italian townscapes. However, whilst the connecting porticoes of the City are an integral part of our proposals, we have opted for a more contemporary "vernacular" in order to avoid the trap of creating a Tuscan pastiche. The plan is a juxtaposition of space defining buildings (the traditional building fabric) and space occupying buildings (the large building volumes of the contemporary City). It is articulated by a clear hierarchy of routes, "towers" of student accommodation, connecting walls, porticoes and public spaces which together create a coherent and legible urban form.

BERTALIA-LAZZARETTO  
意大利博洛尼亚

该项目的总体规划设计、城市设计建筑规划赢得了2001年的国际建筑设计比赛。

该80公顷项目地块是在于博洛尼亚西北边缘。理查德·里德建筑事务所、皮耶罗·萨托戈建筑事务所、理查德·梅耶和帕纳索斯以及阿科工作室是该项目的总体规划设计及建筑团队。其他的设计成员包括：皮耶罗·萨托戈建筑事务所、理查德·梅耶和帕纳索斯以及阿科工作室。客户是博洛尼亚市和博洛尼亚大学。

项目的目的是在博洛尼亚边缘地区创建一个新区来博洛尼亚大学的扩建，包括1000个学生宿舍、1200个住宅单元和相关教育、商业和零售用途的设施容纳7000个教职员工和学生。

该城市设计兼顾了大自然，并响应了意大利城市风格在建筑中的传统是创造建筑的一些字。我们选择了一个更具有现代化的“当铺性”来平衡传统和现代。该规划设计并非将空间重新划分，而是通过一种新的形式，及不同建筑类型来回应传统的大厦建筑。它是由一系列短交错的路线、学生宿舍“高塔”、连接的墙体、柱廊及公共空间共同组成，从而创造了一个连贯而清晰的都市形式。

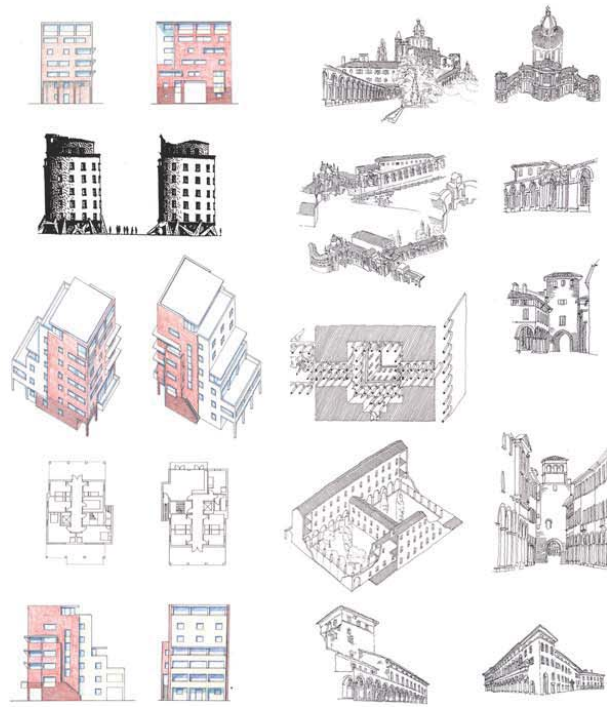
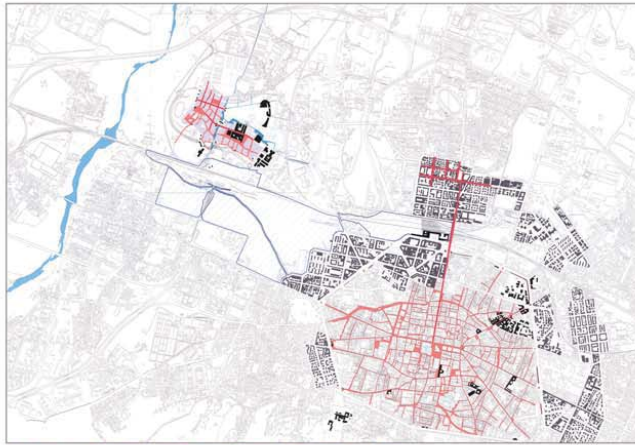

Page 13

Agenda Item 7



Page 14

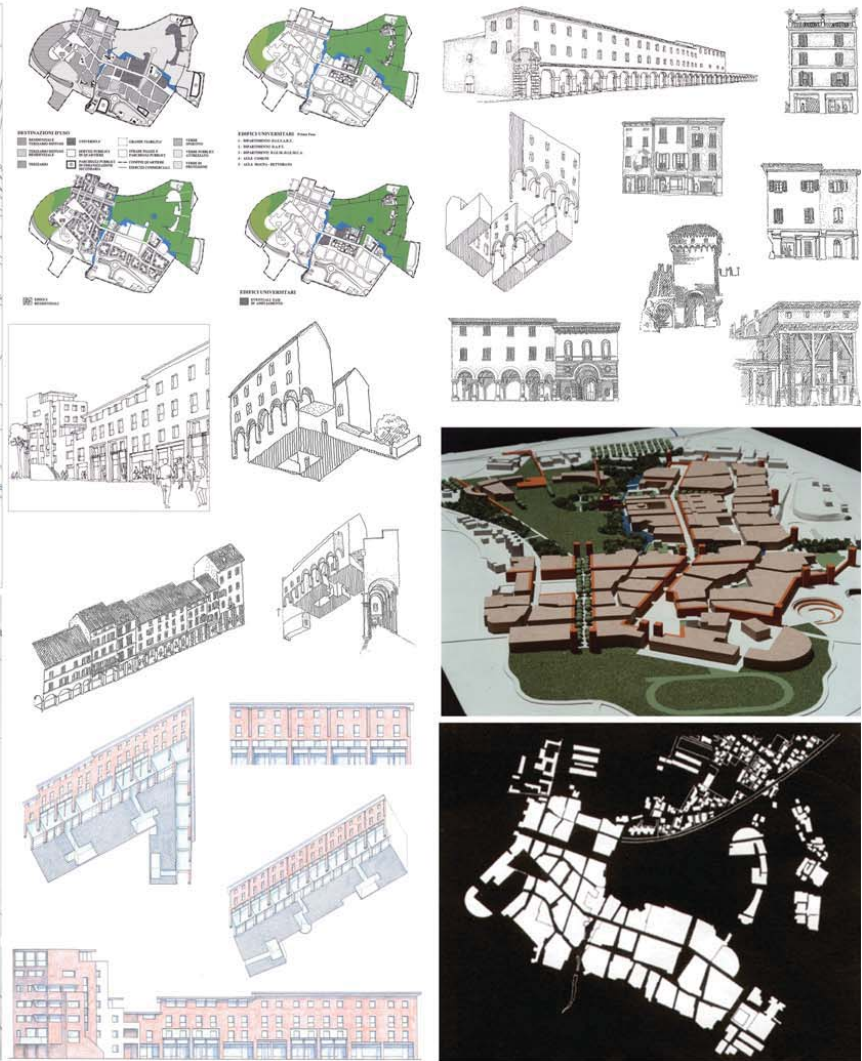

Agenda Item 7

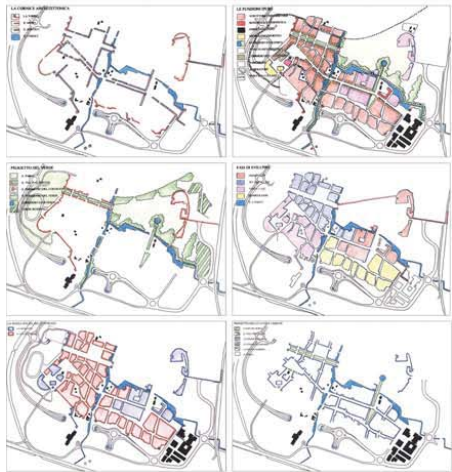



LEARNING FROM THE HISTORICALLY EVOLVED HABITAT

A study of a number of historic European villages, towns and cities were prepared over fifteen years. These studies were funded by a grant from the Commission for European Communities.

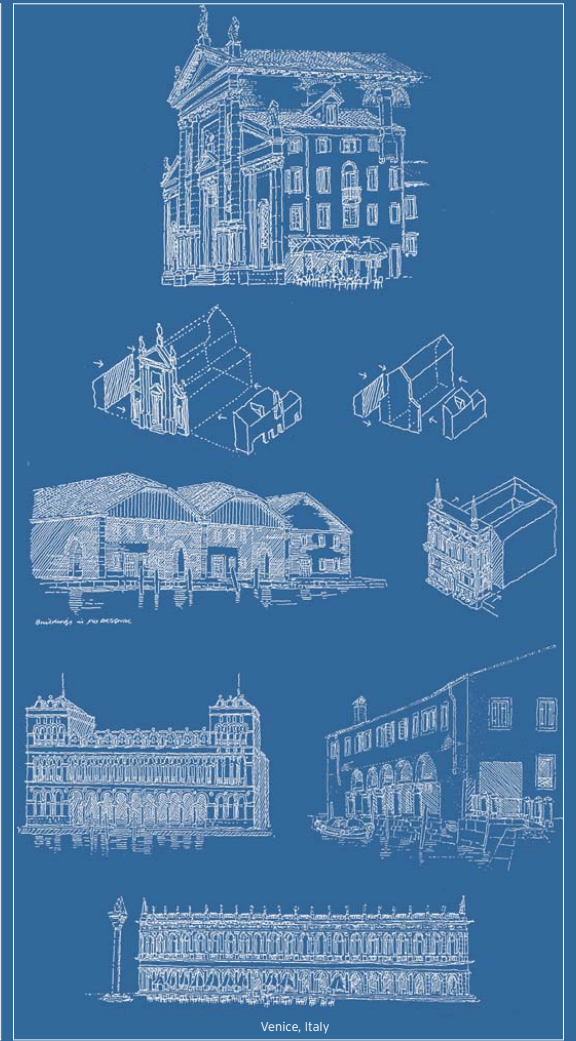
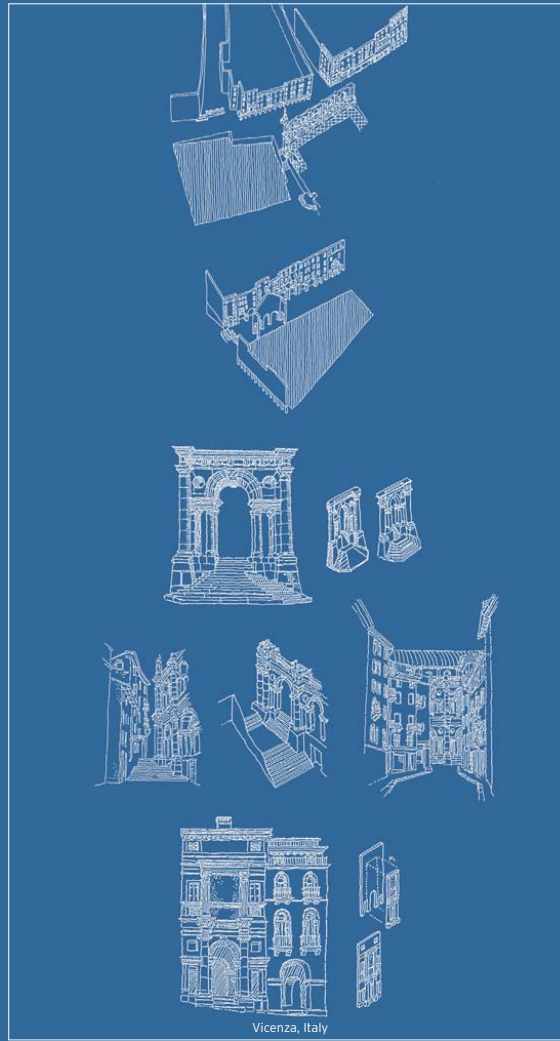
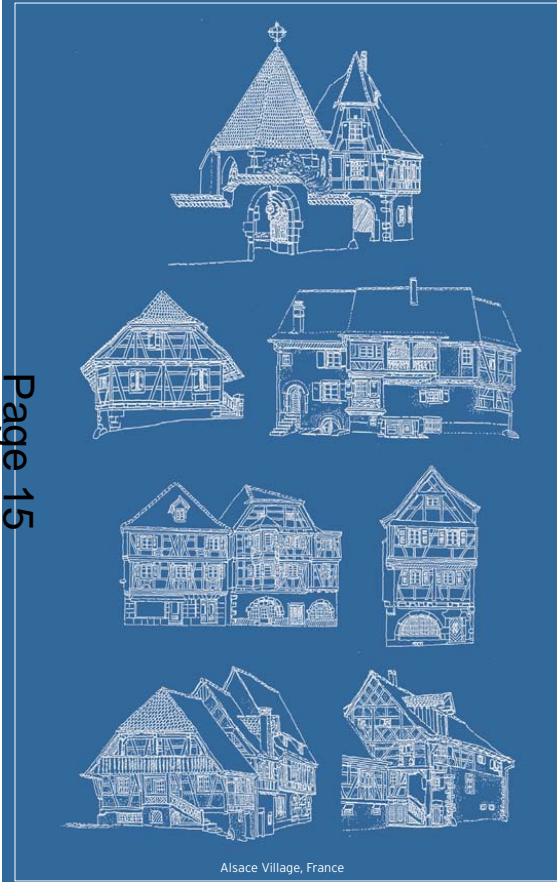

Page 15

Agenda Item 7

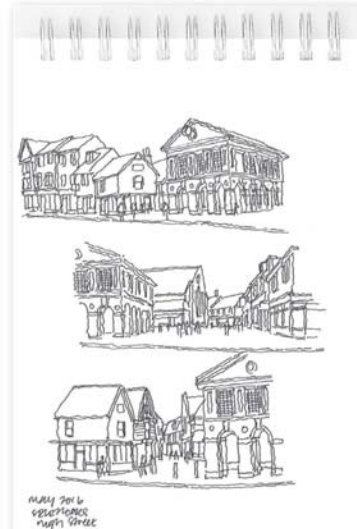

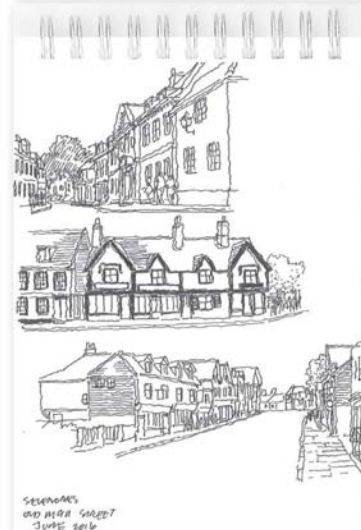
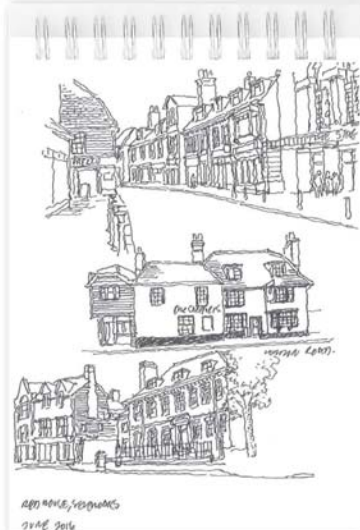
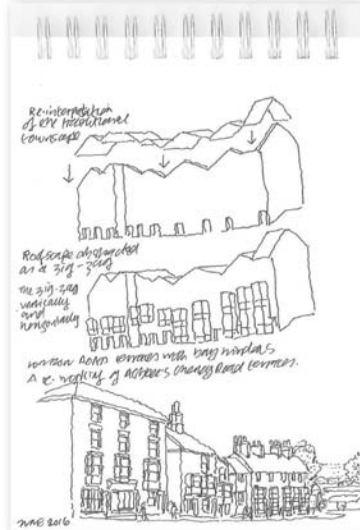
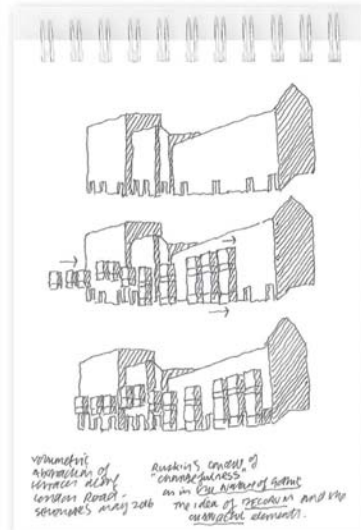
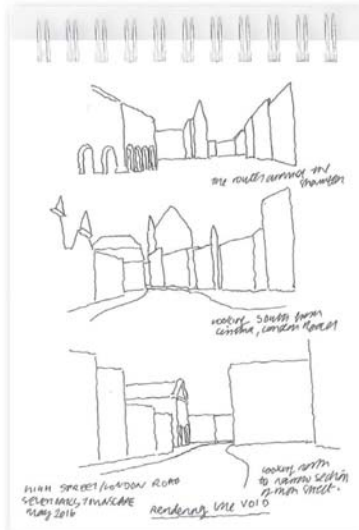
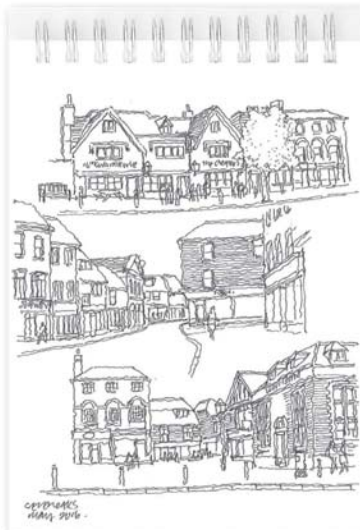
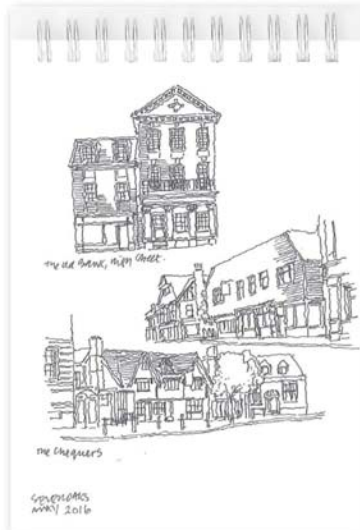



2.00 TRADITIONAL, CONSTRUCTIONAL AND SPATIAL REFERENCES

2.01 One of the questions frequently asked by many architectural design panels is "What is locally or regionally distinctive about your architectural proposals?" It's an easy question to ask, but a difficult question to answer. It's clearly more than just sticking on shiplap weatherboarding or decorative wall filling and yet these materials are a quite characteristic sight.

2.02 The question goes deeper than this, touching on the inventive technical and constructional genius of the region. Two key examples are the Yeoman's House (from the 16th Century) and the Wealden House, a smaller, early 17th Century development.

2.03 The Yeoman's House was, to all intents and purposes, the conversion of a 15th Century open hall house by the insertion of a floor at either end of the central hall, only the hall of which was left open to the roof. A particular characteristic was the jettling out of the storied ends over the ground floor. The reasons for the jettling are obscure, some say to provide extra room (as you have done in the Roma House at Riverside Quarter); some suggest the overhang was created so as to protect the timbers on the ground floor from rain. A more plausible answer is that it was a technique developed by the carpenter to strengthen the house frame, giving him two places instead of one where the joints for the junction of the first floor sill beam with the wall posts could be made (See Illustrations 13-20, 26-31).

2.04 Whilst most Yeoman's Houses are found located (still) in the countryside, the Wealden House was generally built as a terrace row, often in small towns and large villages. The main difference between the two is that the Wealden House, whilst using the same constructional technique, has a small off-centred hall and only one storied end. (Illustrations 20 and 27)

2.05 The other key development in building construction in the regions was the development of lightweight timber framing techniques in the late 18th and early 19th Century particularly suited to weatherboarding and life hanging. Whilst these framed structures were built by carpenters using mortice and tenon, they were a precursor to the "balloon frame" of America. The development of the Balloon Frame, made possible by the manufacture of cheap nails used the same skeleton of thin plates and studs nailed together and running the entire height of the building, past the floor joints. This method, made possible by the cheap nails, converted an expensive and complex craft into an industry with unskilled labour replacing skilled labour (Illustrations 21-25).

2.06 Professor Brunskill makes a distinction between "vernacular architecture" (by which he means the smaller domestic house or terrace) and the "polite house" - usually the larger villas and mansions often designed by an architect. In a sense we see building and architecture as distinctly different, yet related. In fact, many of the Arts and Crafts architects looked to simple buildings in the countryside (hay barns, the small cottages, the oasthouse, etc) for inspiration.

2.07 This "accommodating" of building and architecture has also influenced our views on the making of space. Whilst the architecture of the Woods at Bath was clearly designed to "define" space in all its grandeur, (Illustrations 32-35) the smaller towns and cities with their more "vernacular architecture" (or building) have successful spatial hierarchies also (Illustrations 36-41). But one is created architecturally, the other by the "pushing and shoving" of buildings' ground space. But one is designed (the former), the other just "happened" (the latter). One is grander, more formal and repetitive in character, the other more informal, varied and irregular in character. (Illustrations 38 and 41)

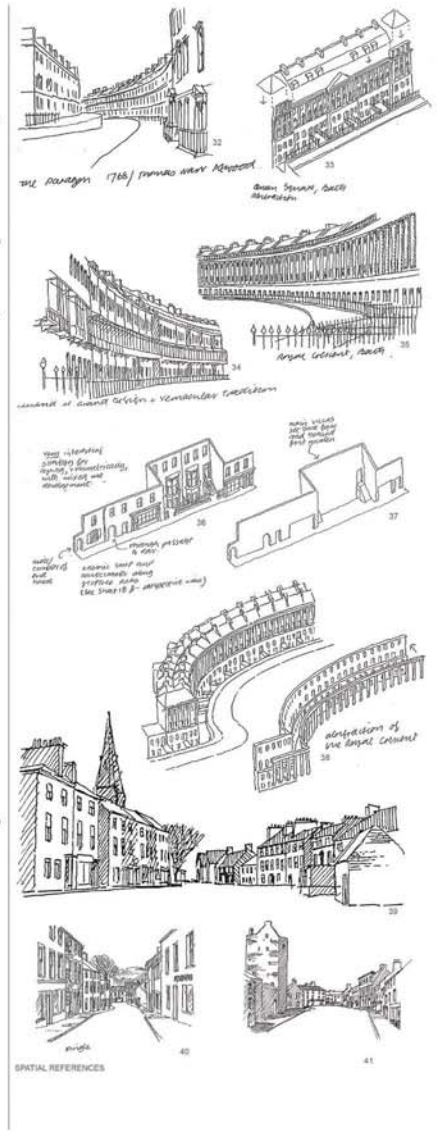

SPATIAL REFERENCES



TRADITIONAL REFERENCES

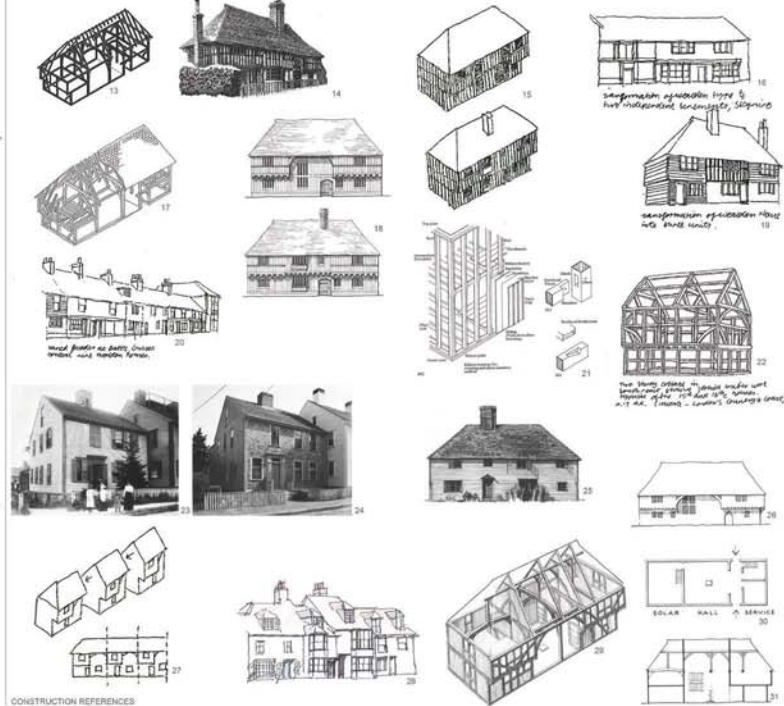

CONSTRUCTION REFERENCES

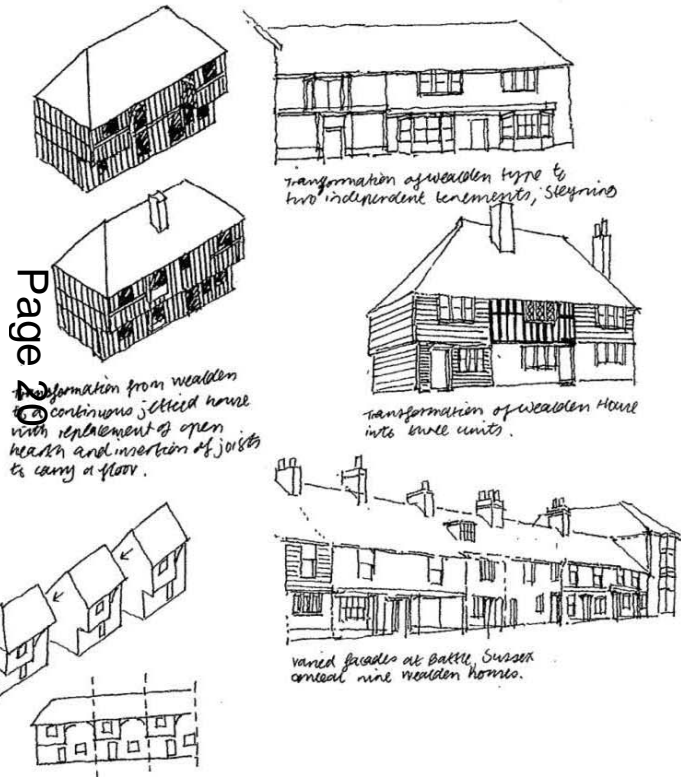

BUILDING TYPOLOGY: THE WEALDEN HOUSE

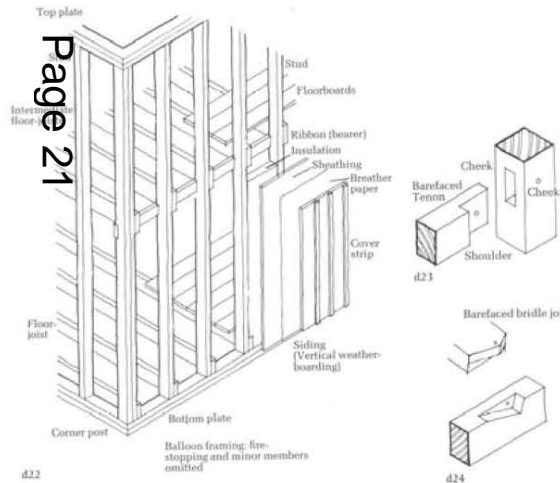

Agenda Item 7

STRUCTURAL INNOVATIONS: BALLOON FRAME



Agenda Item 7







EXTRACT FROM THE FILM 'WITNESS'



BUILDING IN A CHINESE VILLAGE

Page 23

Agenda Item 7



Page 24

Agenda Item 7



Page 25

Agenda Item 7



Page 26

Agenda Item 7

LOWER MILL ESTATE  
Cirencester

RRA are masterplanners and architectural designers for the Clearwater and Howells Mere phases of Lower Mill Estate, a community of second homes on a 550 acre former quarry site set in the Cotswold Water Park. Planned for the Lower Mill Estate Ltd and Conservation Builders Ltd, the practice is currently collaborating with Colin Toms and Partners as structural and civil engineers, Peter Brett Associates as flood risk consultants with the landscape design and ecological input by The Landmark Practice.

The site is an open landscape – informal, specifically native and with an emphasis on bio-diversity. We were appointed for the third phase and beyond. Our design, whilst more overtly contemporary in character than the earlier phases, responds to the traditional building character of the area with its varied roofline and informal, organic-like planning.

None of the houses has a fenced-in residential curtilage. There are no garages, for all parking is grouped appropriately throughout the site. The buildings are grouped informally, private outside space provided by loggias, two storey galleried gable ends or arading, projecting balconies, deck terraces and roof terraces, all maximising the views out across the landscape of lakes and meadow lands, and shallow water canals and streams.

There are over 20 standard house types, which have a number of variants, that create the common "building language" or vernacular for the site. What is particularly unique is that we have several "landmark houses" to be designed by leading UK and international architects. These houses are the 'architecture' of the site and act as focal points within the village-landscape, much as the mansions and 'polite' houses (to quote Brunskill) do in traditional villages and smaller towns.

LOWER MILL ESTATE  
英国塞伦塞斯特

“清德联营公司是负责Lower Mill Estate的水体(Howells Mere)两个发展阶段的总体规划 and 建筑设计。这是一个位于Cotswold水上公园40英亩的别墅社区，其前身是采石场。该项目由Lower Mill Estate Ltd, Conservation Builders Ltd 两家公司与Colin Toms and Partners的结构性土木工程师合作。其洪水风险顾问是Peter Brett Associates。The Landmark Practice负责它景观生态输入。”

“一个开放的地形景观，具有自然性的、特异的物种，以生物多样性为根基。我公司负责第三阶段及其之后的发展任务。相比与前两个阶段的工作，我们的设计具有明显的现代化特色，同时也呼应了当地传统建筑特色。带有各式不同的屋顶曲线及带有随意自然性的规划设计。”

设计的房屋无一带有围墙，也无各自的车库。停车场分布在该场地的适当区域中，建筑物成群结对，具有随意性。私人室外空间带有凉亭、两层的带长廊的露台或拱廊、突出的露台、甲板台和观景露台。这些都最大化地提供朝向湖泊、草地、浅水运河及河流的视野。

二十几种的标准化房屋类型，并带有一系列的变异性。来创造出共同的“建筑语言”或该地区的地方特色。尤为独特的是，几个“标志建筑”是由英国和国际著名建筑设计的。这些房屋是该地区的“建筑风格”，并在这个村庄规模的地区，发挥着焦点的作用。尤其是在传统乡村和小城镇中的公馆和“上层社会的”住宅（引用Brunskill）。



Page 27

Agenda Item 7

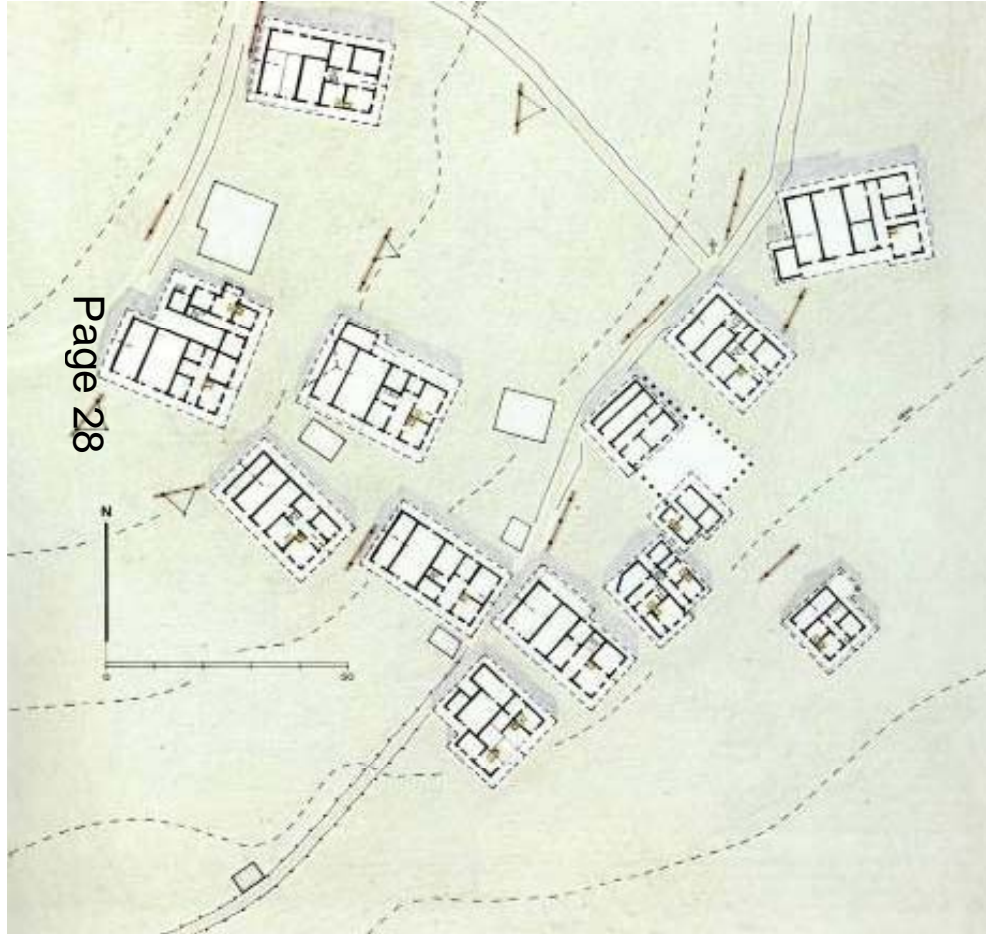

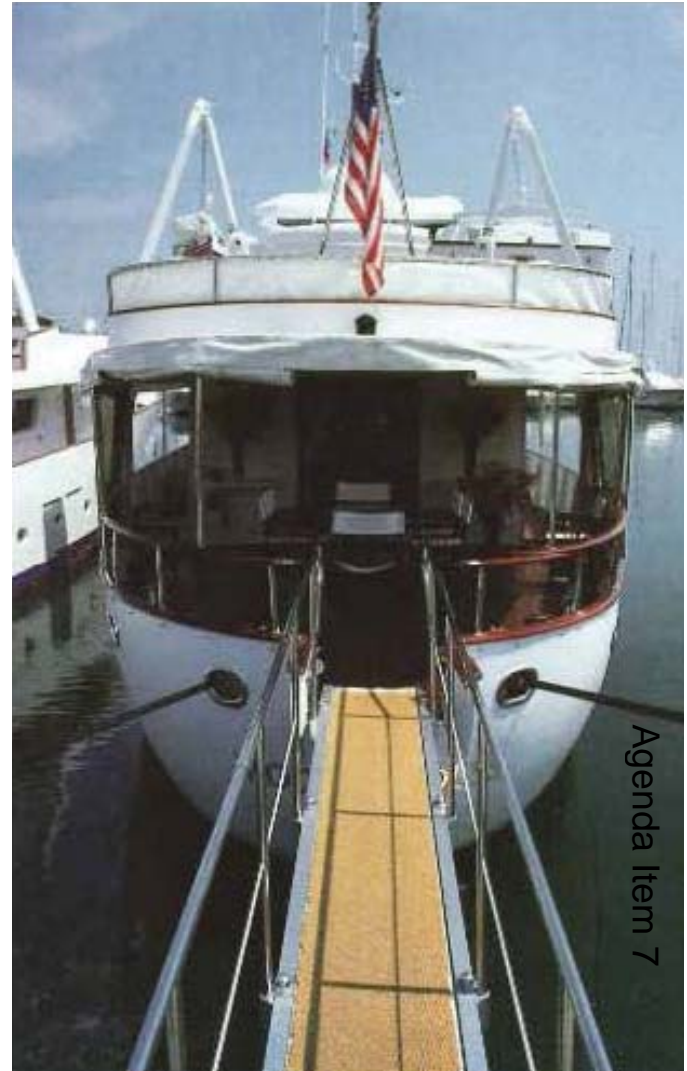

Page 29

Agenda Item 7



Page 30

Agenda Item 7



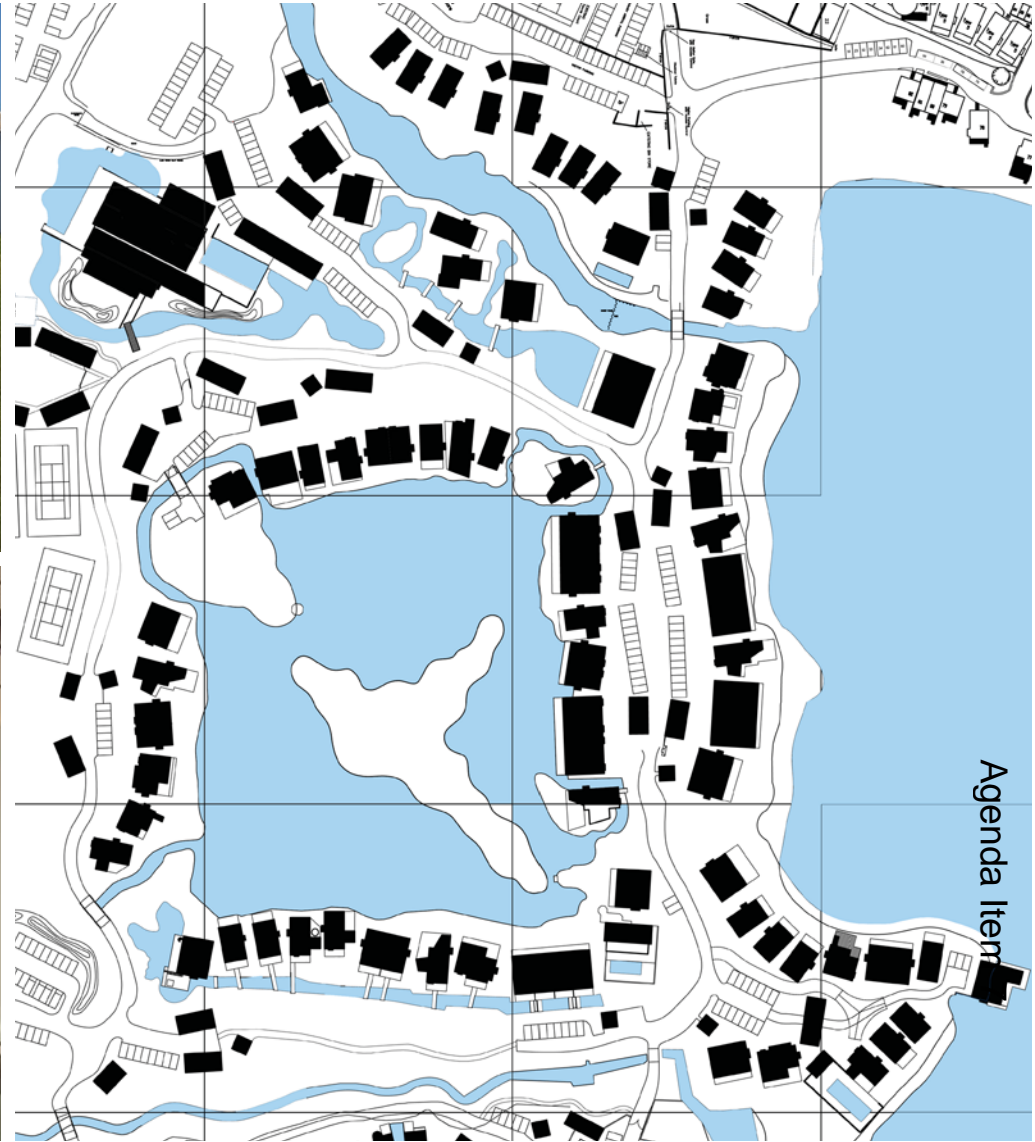

Page 31

Agenda Item

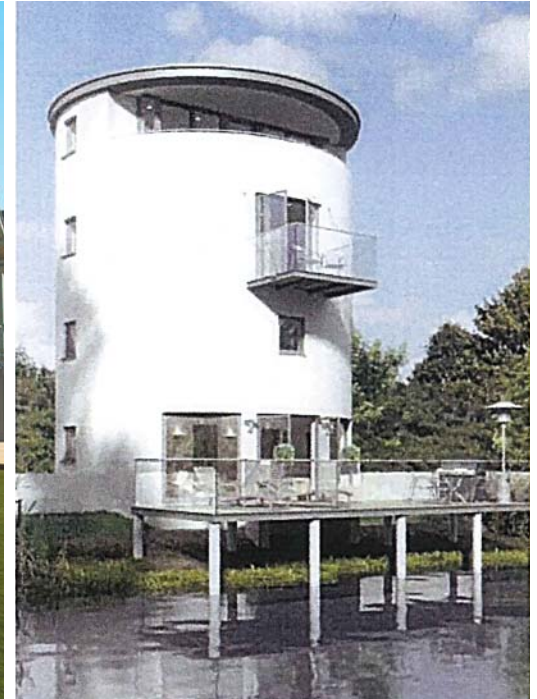

Agenda Item 7

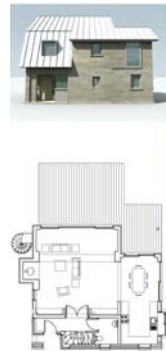



Page 33

Agenda Item 7



Page 34



Agenda Item 7

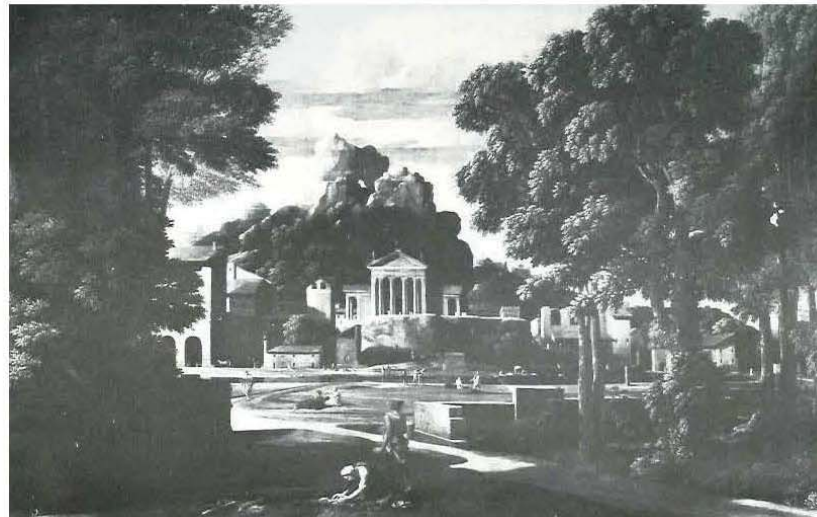
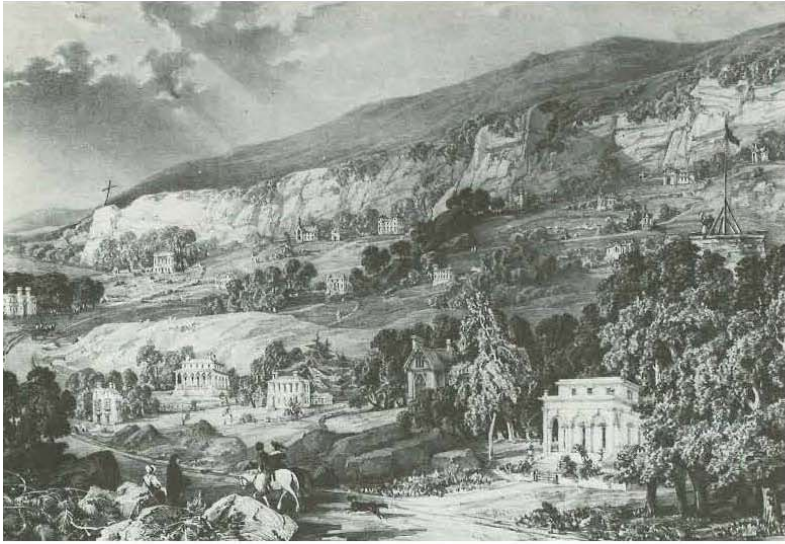

Page 35

Agenda Item 7

THE MODEL VILLAGES AND POUSSIN PAINTING: THE LATE 18TH AND EARLY 19TH CENTURY IDEA OF TRANSFORMING THE ENGLISH COUNTRYSIDE INTO PAINTERLY EQUIVALENTS OF LANDSCAPES CREATED UNDER THE ITALIAN INFLUENCE.



Page 36



Agenda Item 7

THE CHINESE CONCEPT OF LIVING WITH THE LANDSCAPE - FENG SHUI



Page 37

Agenda Item 7



Page 38

Agenda Item 7





Page 39

Agenda Item 7



Page 40

Agenda Item 7



Page 41

Agenda Item 7





Page 43

Agenda Item 7



Page 44

Agenda Item 7



Page 45

Agenda Item 7

NANSHA BAY  
China

The site for the new town of Nansha Bay is a former quarry site of 2,500 acres bounded by the Pearl River along the north-east and a range of hills, forests and mountains along the south west.

The proposed development, of which the first phase is already in construction, is a joint venture between the Henry Fok Group of Companies and the local authority – The Guangzhou Nansha Development and Construction Co. Ltd

The Masterplan strategy is designed to create a compact and dense form similar to the European urban village, fostering a mixed use, vibrant town or city 'townscape'.

The 'urban village' concept is to create a green, sustainable, ecologically balanced and high density town or city in which to work and live. The urban village strategy can be developed incrementally, is economically deliverable, has a masterplan sufficiently flexible so as to accommodate change, and is an environmentally managed, low carbon, attractive, human scaled model for the 21st century big enough to support a wide range of uses and amenities, yet small enough for all its buildings to be within easy walking distance.

Page 46

沙湾新城前身是一个占地2500英亩的采石场。其东北面为珠江所围绕，西南面为一系列的丘陵和山脉。

该项目的规划设计是由霍英东集团及当地政府共同出资成立的广州南沙开发建设有限公司所负责的。

总体规划设计的策略是创建一个密集紧凑的城市布局，类似于欧洲的urban village，从而创建一个带混合使用的、充满活力的城镇或城市景观。

"Urban village" 的理念是创造一个绿色的、可持续发展的、生态平衡的、高密度的适宜工作和生活的乡镇或城市。逐步发展的urban village策略在经济上是具有可实施性；在总体规划上具有足够的灵活性，以适应任何变化；在环境上，具有可管理性、低碳能及具有吸引力的人文尺度的模式。在21世纪，其规模又足够大以支持广泛的用途及设施，但又足够小使建筑物位于步行距离之内。



Agenda Item 7



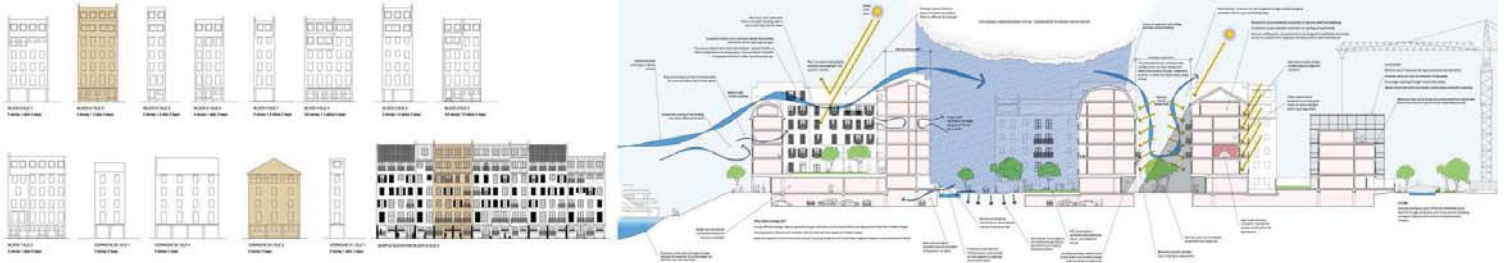
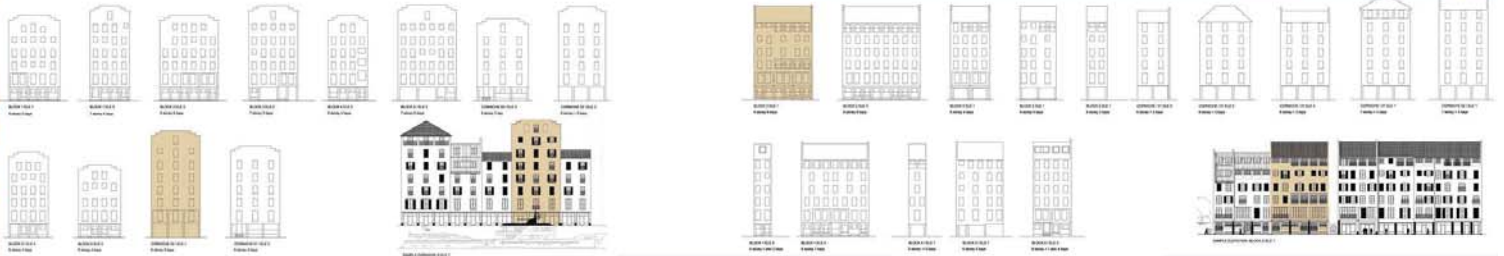

Agenda Item 7



Page 48

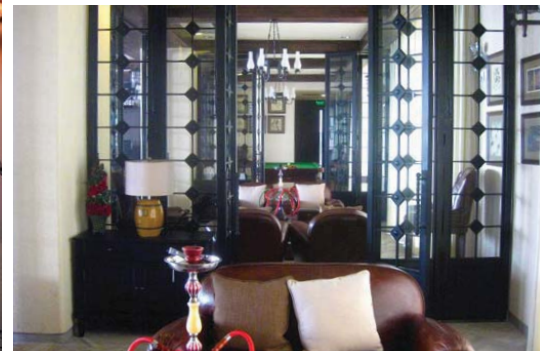

Agenda Item 7



Page 49

Agenda Item 7



Page 50

Agenda Item 7

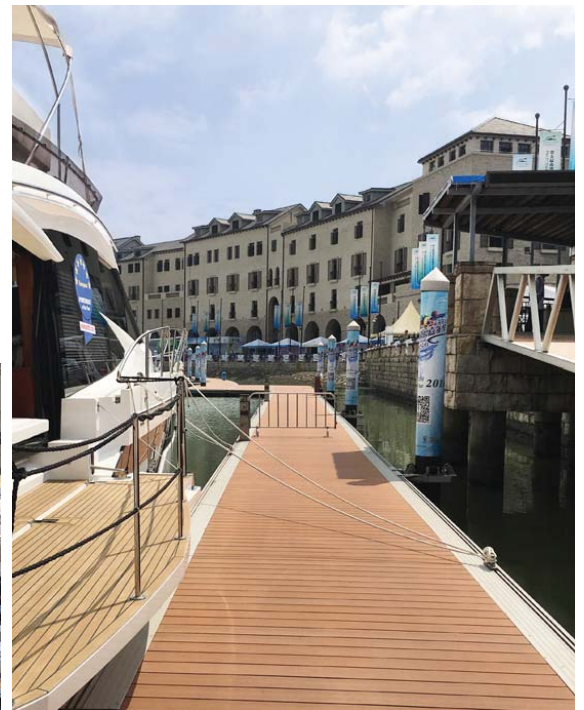

Page 51

Agenda Item 7



*Piazza San GIUSEPPE  
Remains of old Roman street  
plan taken up by domestic buildings.*

Page 52

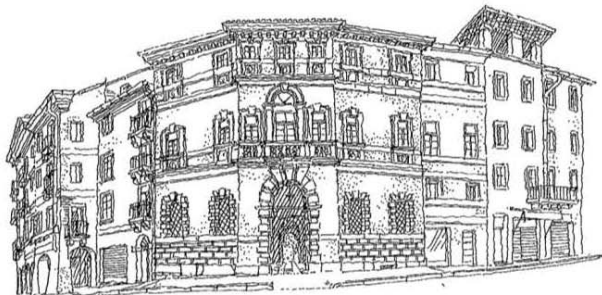
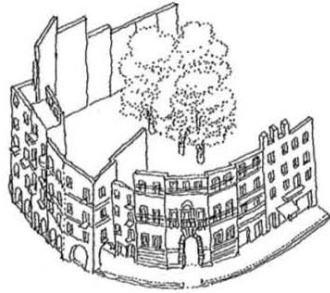

*Piazza San GIUSEPPE*



Agenda item 7



ACCRETIONS: P. SAN GIUSEPPE, VICENZA AND PLACE VENDOME, PARIS - THE "FRAMEWORK" FOR LATER INFILLS AND EXTENSIONS

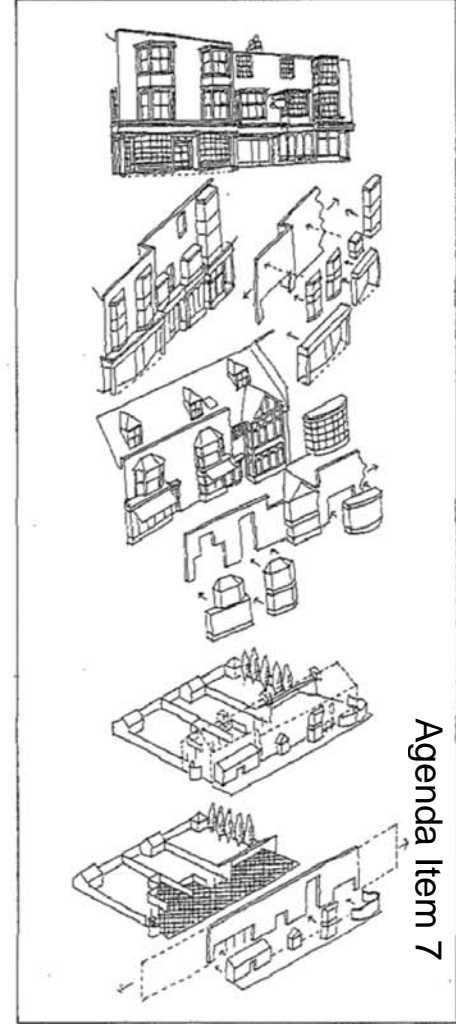
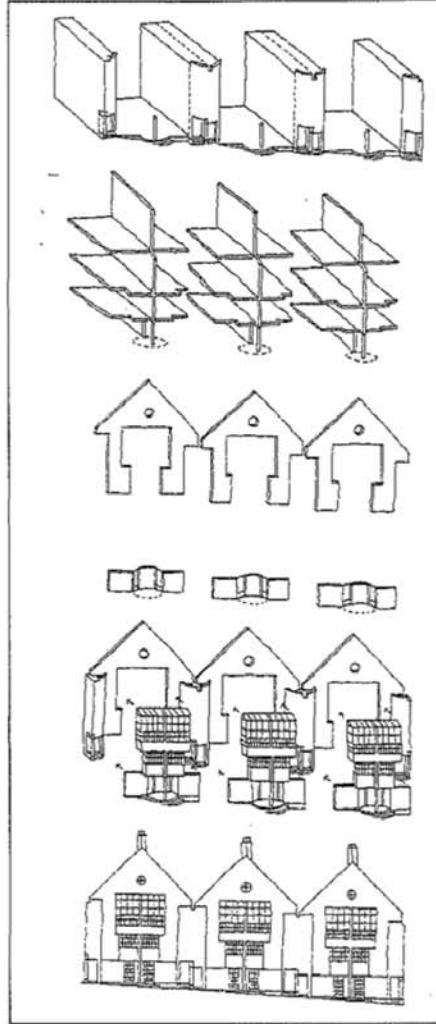
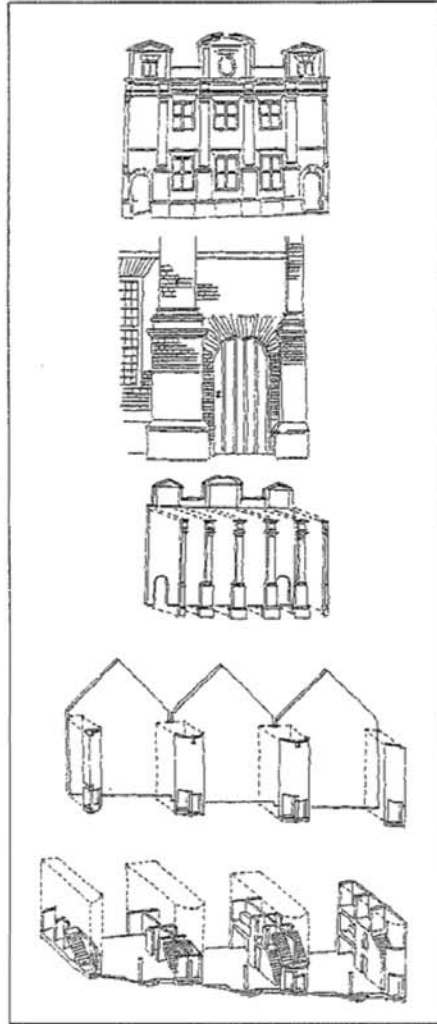
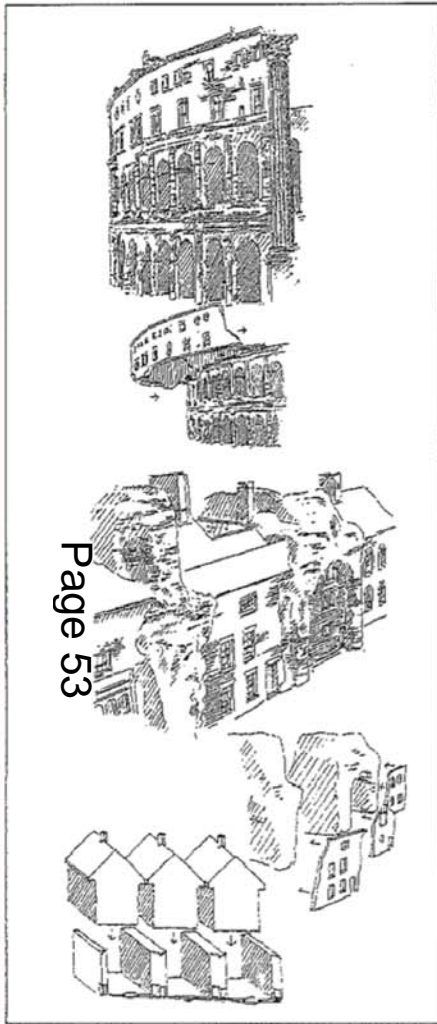

Agenda Item 7

ACCRETIONS: RYE HOUSING - RRA PROJECTS FROM 1980'S



The Townscape Ensemble/ RRA

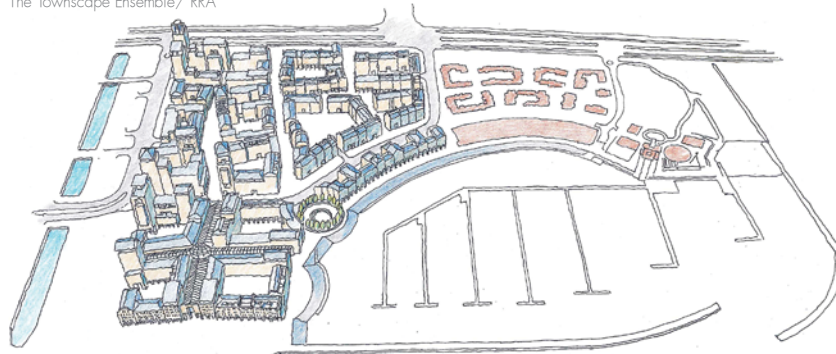

Space Defining Buildings/ RRA

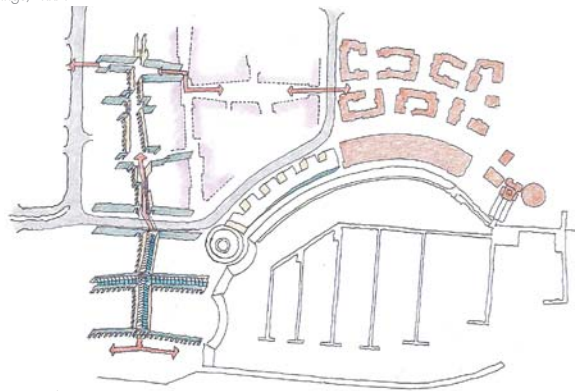

The Connecting Routes, Nansha Townscape/ RRA



Serial Vision -- Creating The Walkable And Healthy City/ RRA





Page 55

Agenda Item 7

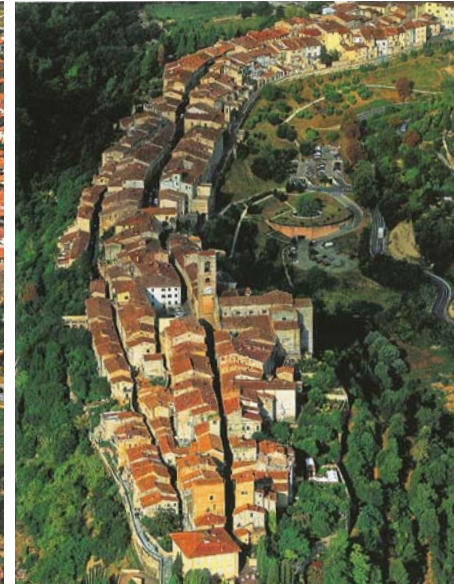
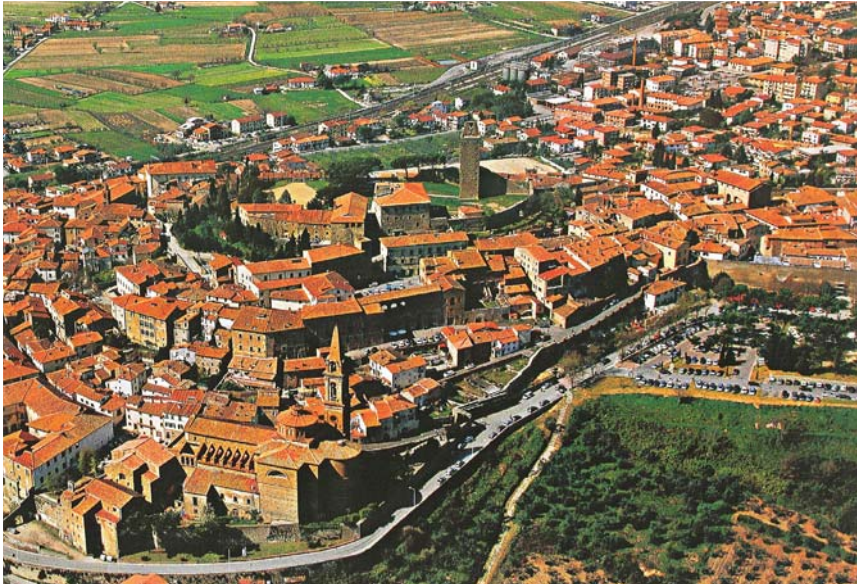

HOW CONTOURS CREATE LINEAR, ENCIRCLING OR HYBRID PLANNING PATTERNS TRADITIONALLY

NANSHA HILL VILLAGE  
China

Masterplan for a hill village on a saddle of land in the hills above the new town of Nansha Bay

Surrounded by two golf courses, the hour-glass like plan has a denser more urban quarter on the higher ground in which narrow terrace streets encircle a green hill from which protrudes a curving square and 'belvedere'.

An amphitheatre, pergola walk and public garden connects the high density village to the lower less dense streets of villas and a large hotel located along the edge of a promontory with spectacular views out towards the Pearl River Delta.

南沙山庄小居  
中国

该项目是对位于丘陵上的一块马鞍状地块进行的总体规划设计。其地势是高于南沙湾新城。

马鞍状的平面规划被两个高尔夫球场所围绕。该设计旨在创建密集的更具城市化的山丘小居，带有蜿蜒绿色丘陵地形的狭窄街道、弧形广场和观景楼亭。

一个圆形露天剧场、凉亭走廊及公园把高密度的山丘小居与低密度的别墅小区连接在一起。一个位于场地边缘的大型酒店拥有朝向珠江三角洲的壮观视野。

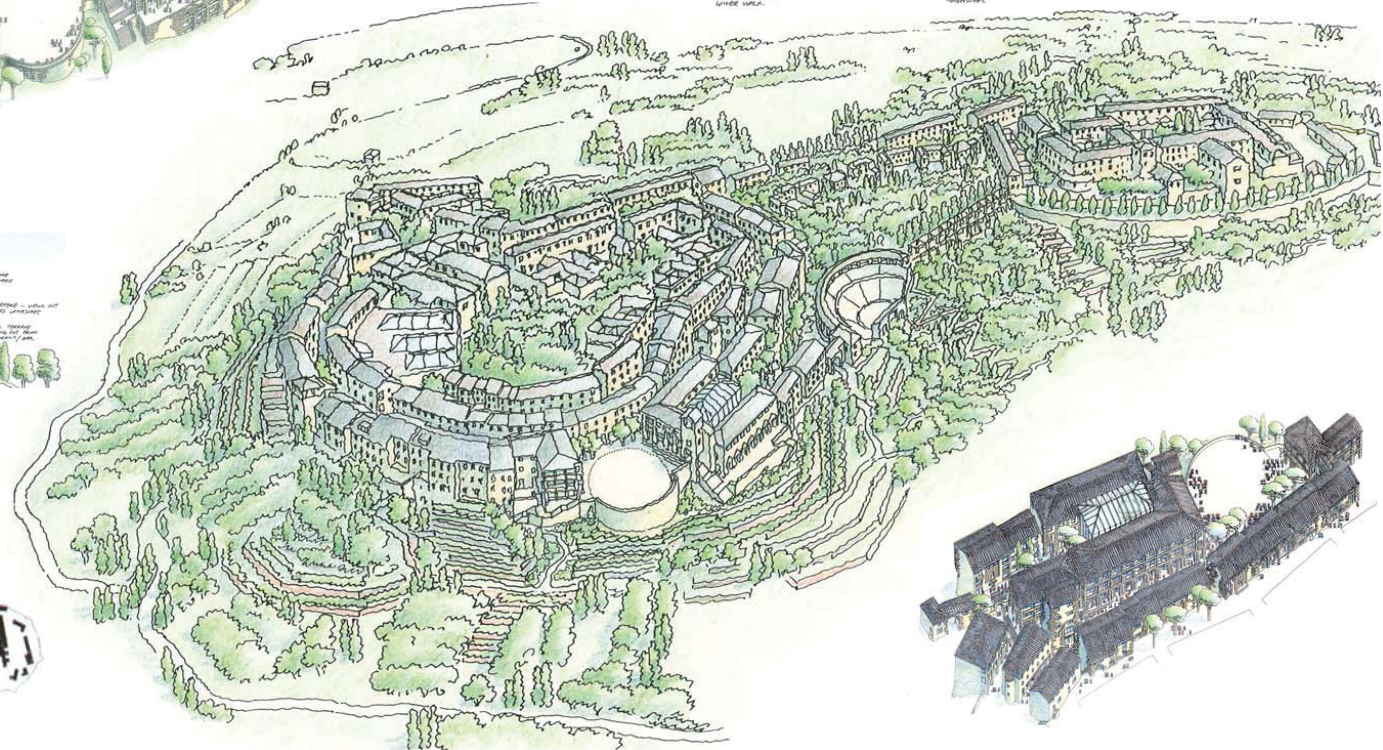
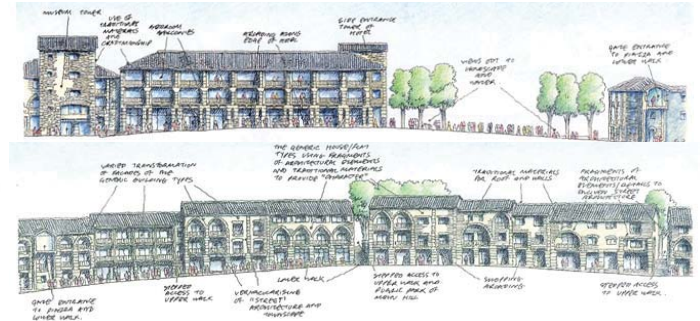
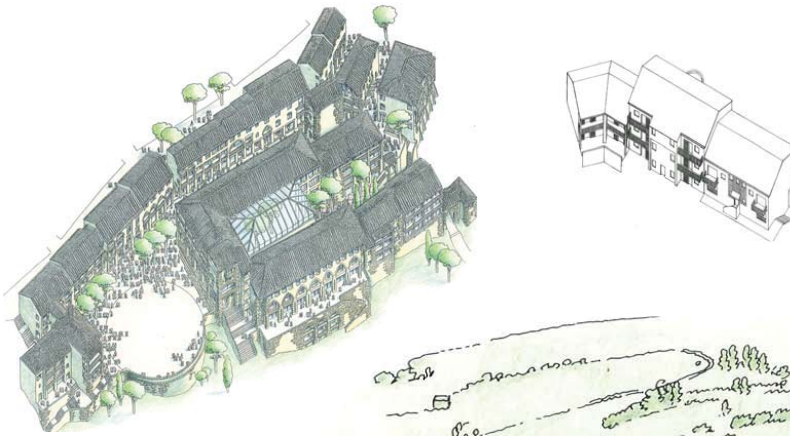

Page 57

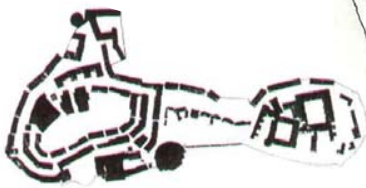
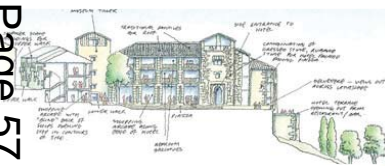

Agenda Item 7

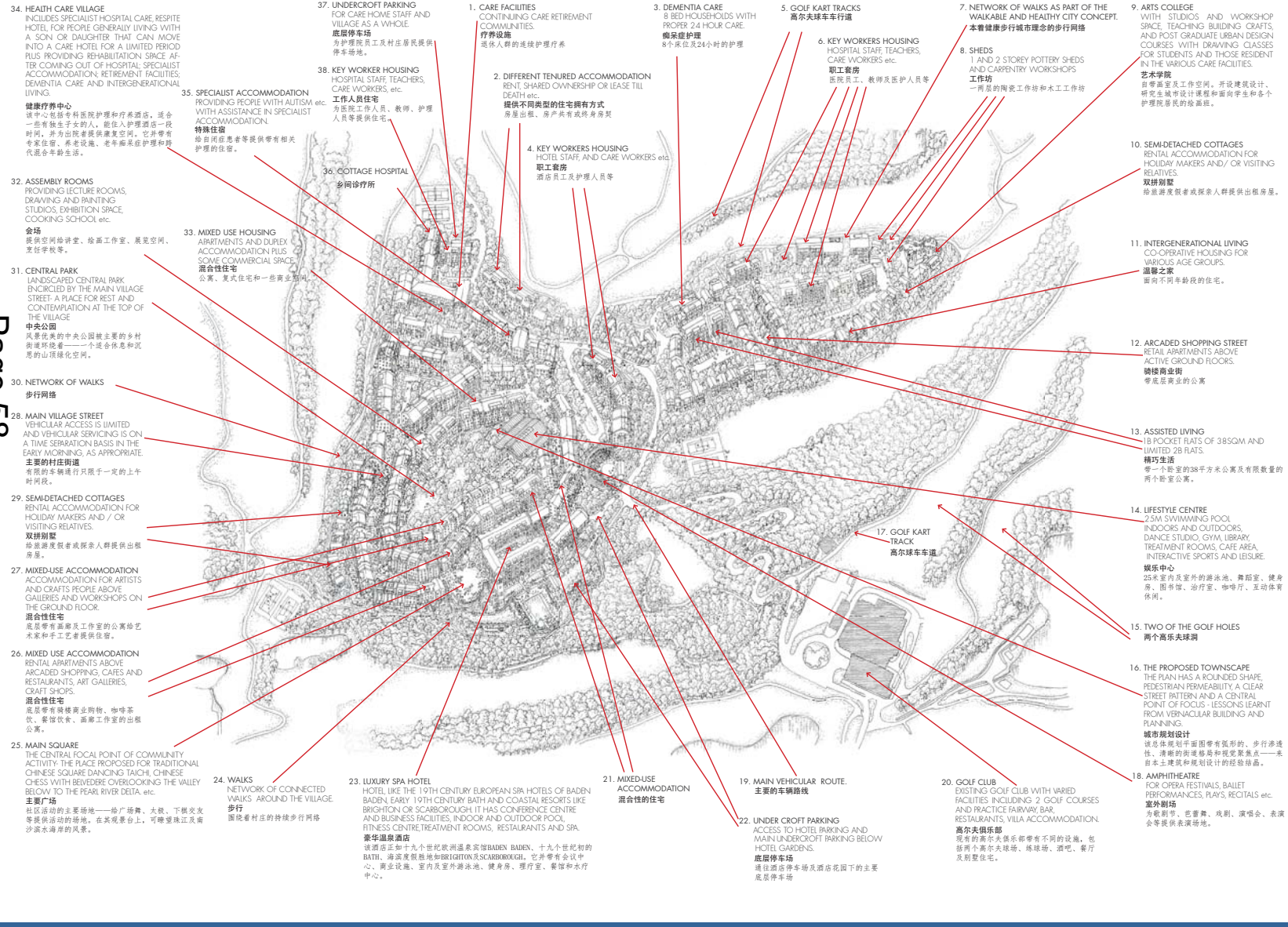

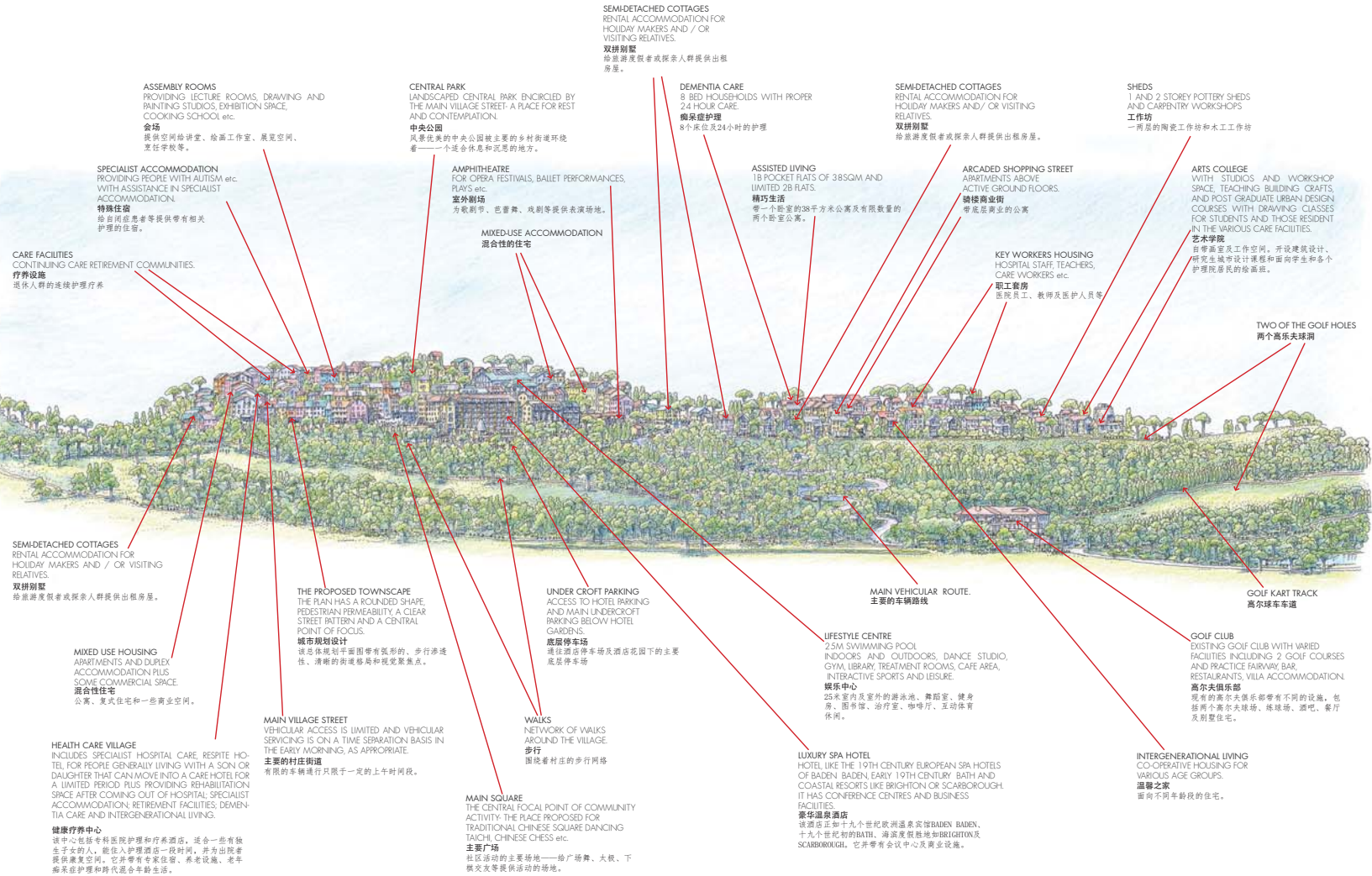

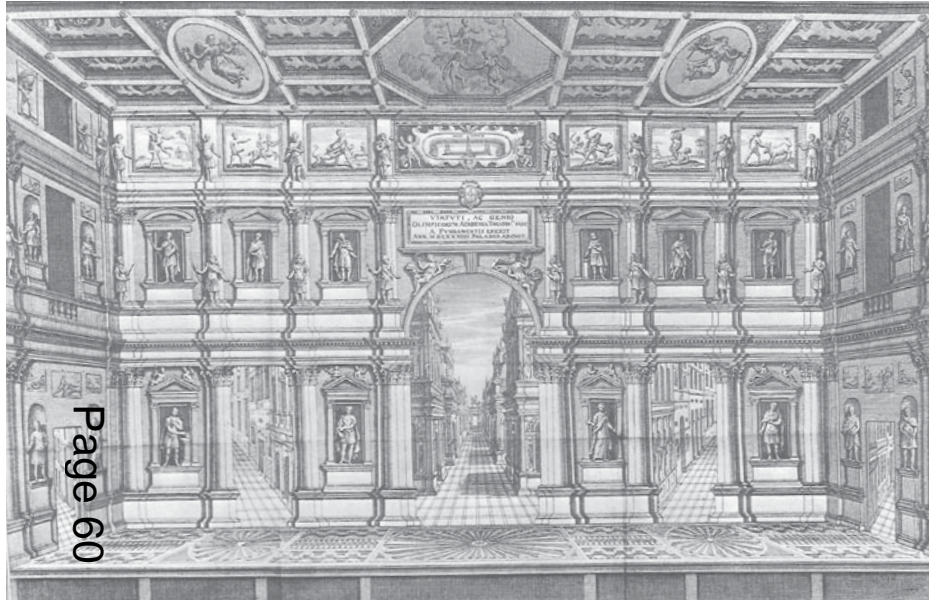

Page 60

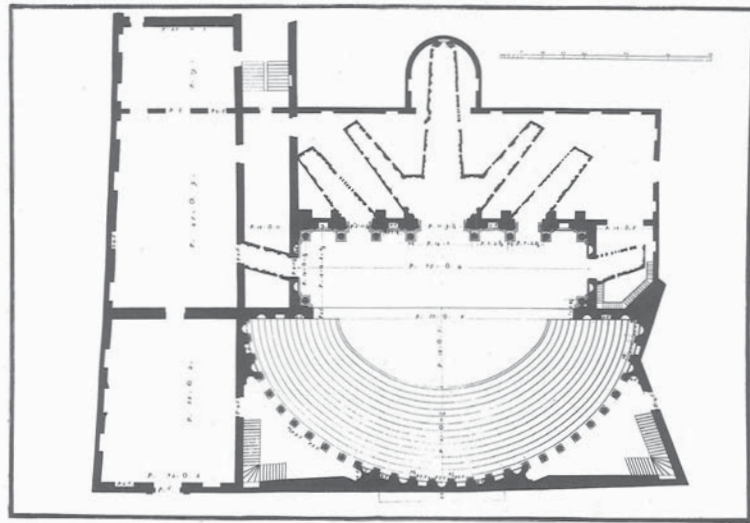

Facade of the Casa Cogollo 1559-62

boldly needed blank panel remain essential from distance as seen retrospectively down street. the design is not particularly vivid in the multi-form, multi-colored (low definition) scene of this on the street.

Agenda item 7

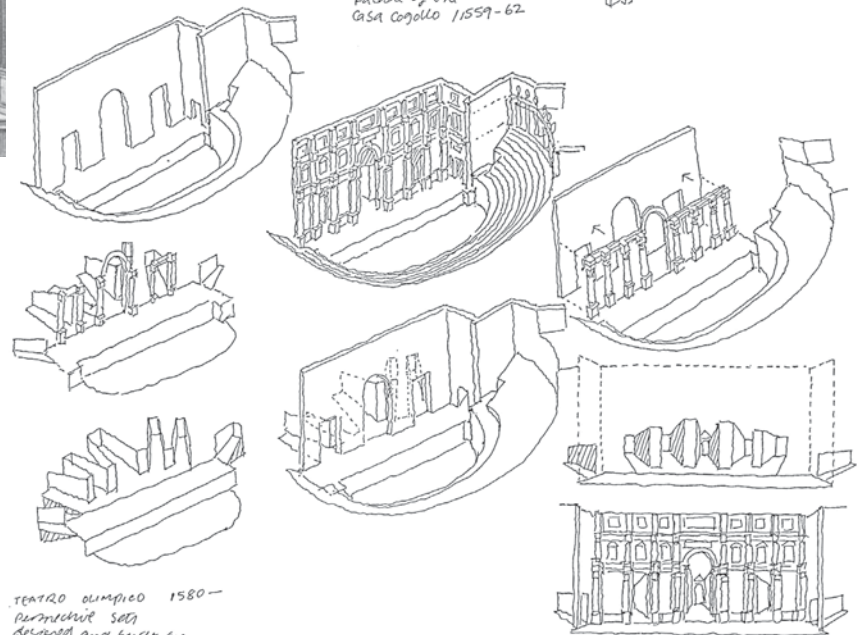

TEATRO OLYMPICO 1580 - perspective seen designed and built by Scamozzi 1584-5 - interesting to view make study of Borromini's Palazzo Spada, Rome.

"STREET AS PICTURE" ✓

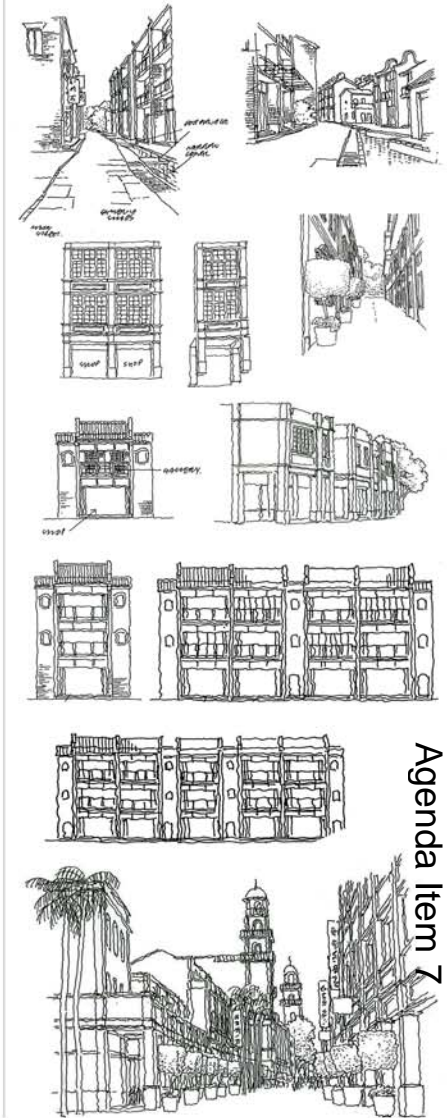
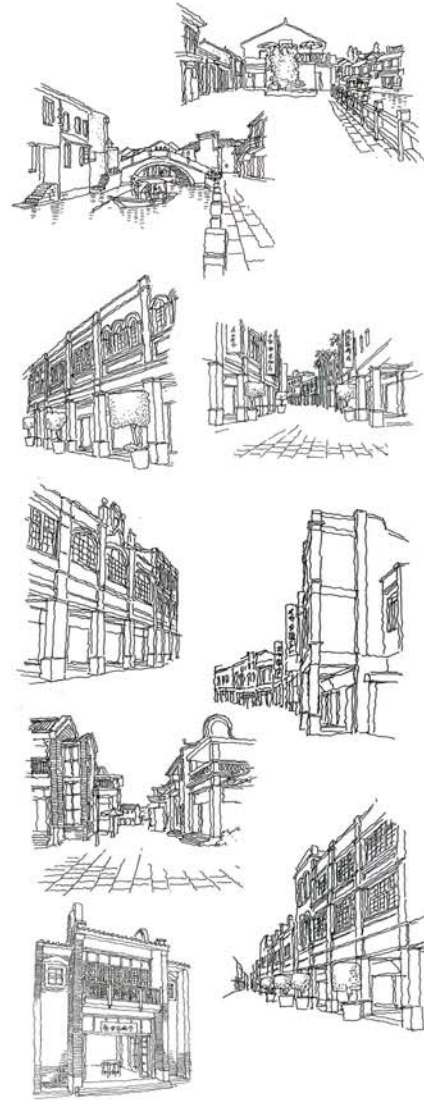
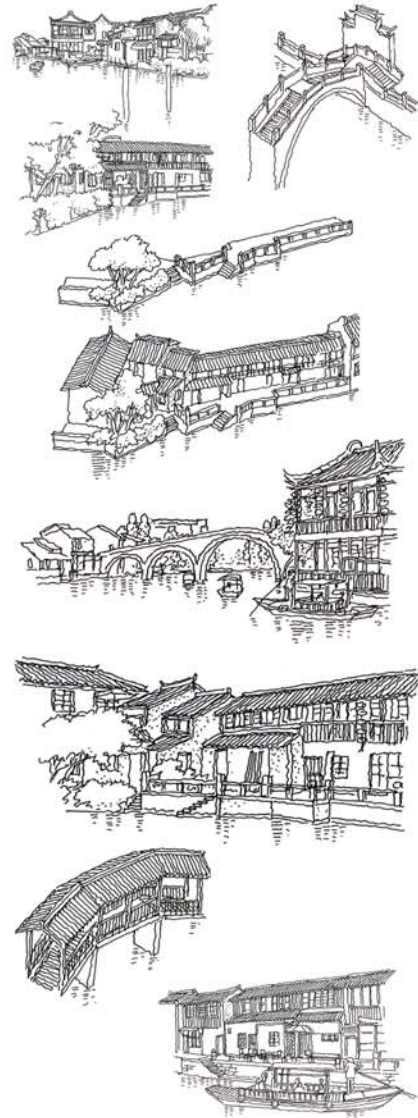

Agenda Item 7

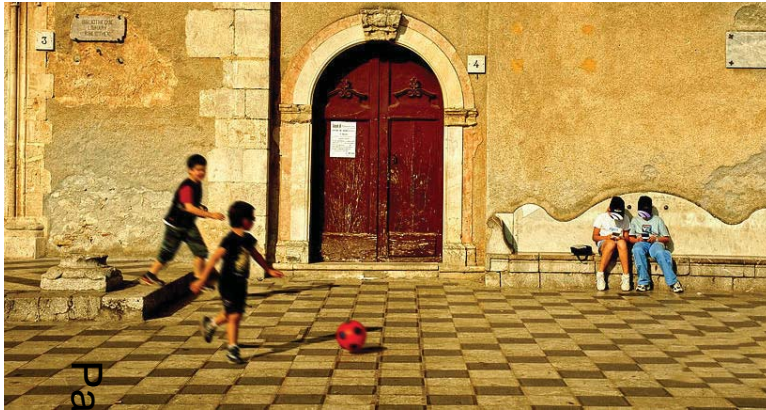

Page 62







Page 63

Agenda Item 7





Page 65



Agenda Item 7



Page 66



Agenda Item 7



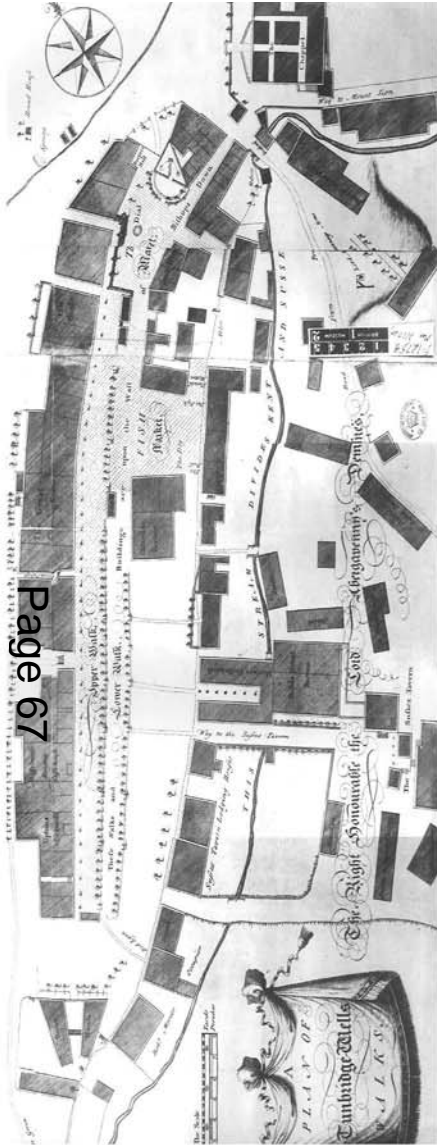

Page 67

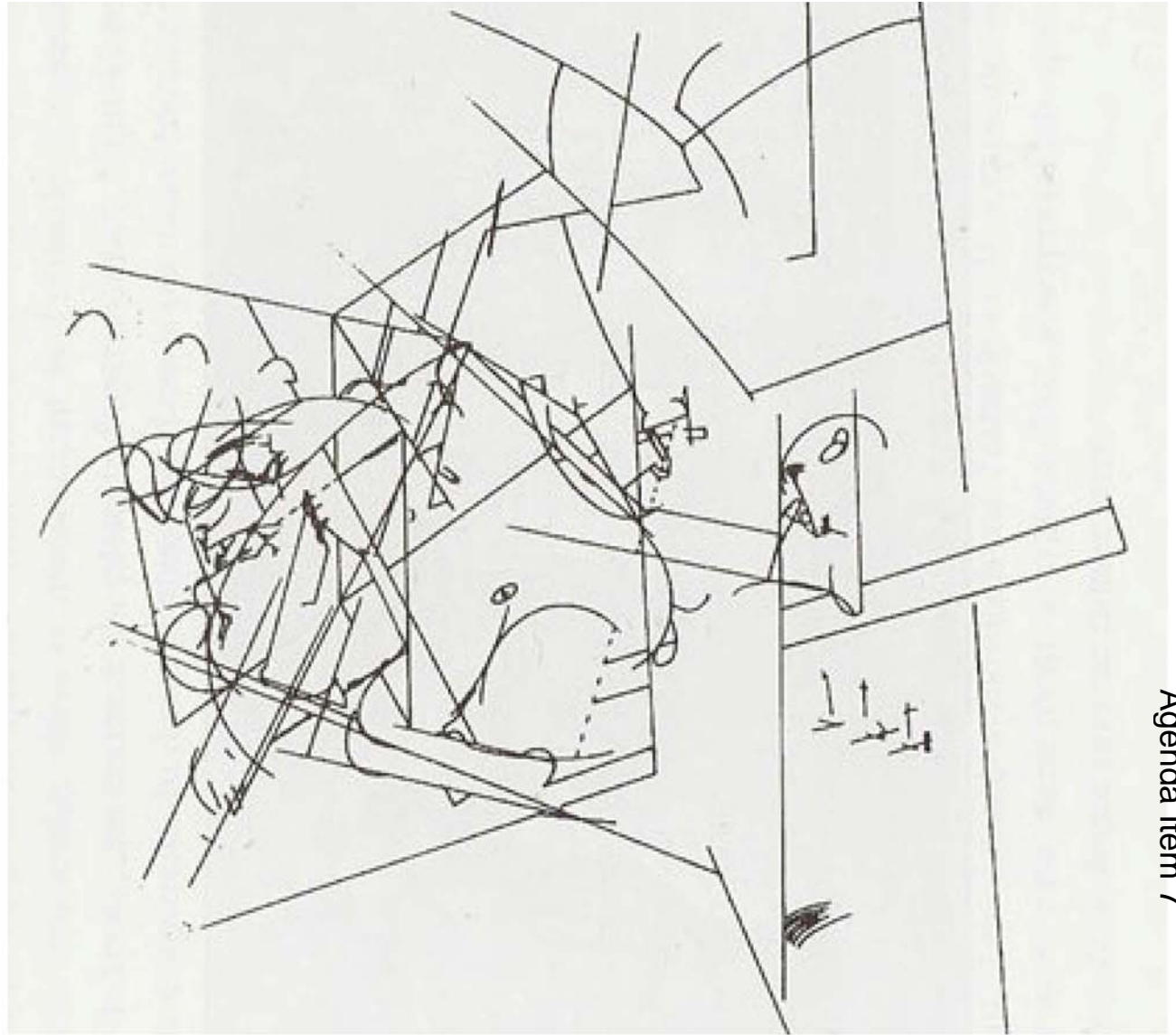

Agenda Item 7

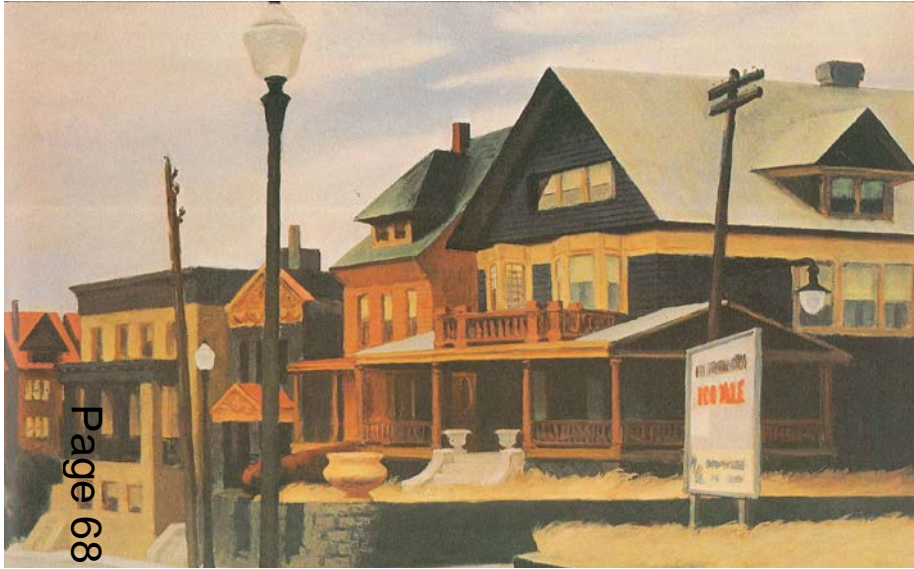

Page 68



Agenda Item 7

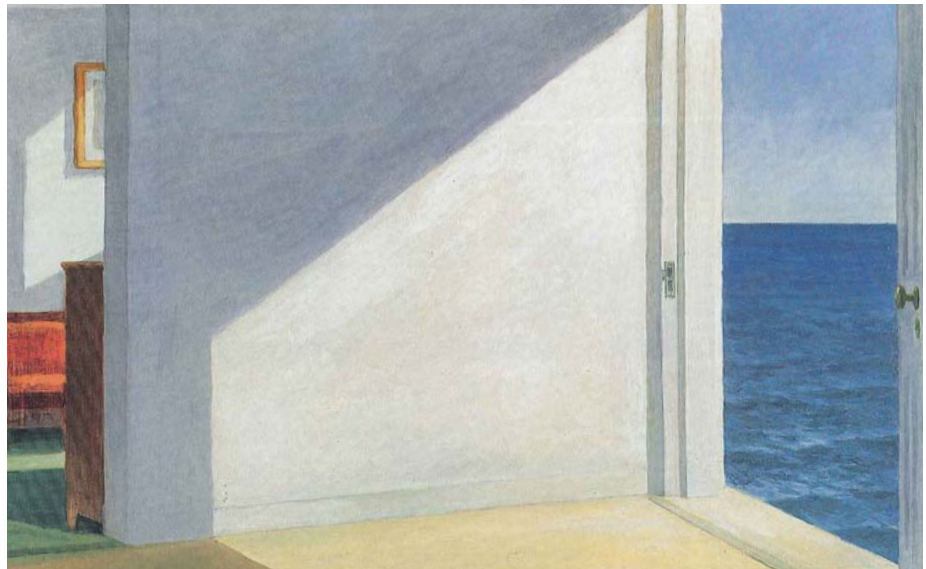



Page 69

Agenda Item 7

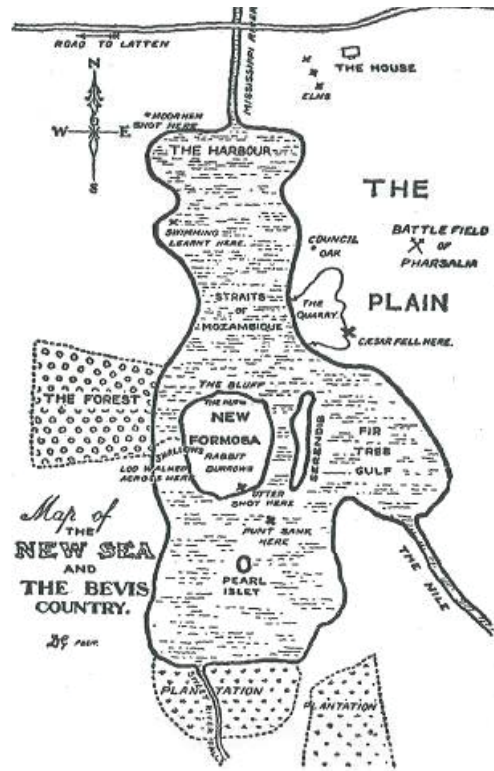

“ON THEIR WAY HOME THEY PAUSED A MOMENT UNDER THE GREAT OAK AT THE TOP OF THE HOME FIELD, AND LOOKED BACK. THE WHOLE SOUTH BURNED WITH STARS. THERE WAS A ROAR IN THE OAK LIKE THE THUNDER OF THE SEA. THE SKY WAS BLACK, BLACK AS VELVET, THE BLACK NORTH HAD COME DOWN, AND THE STARS SHONE AND BURNED AS IF THE WIND REACHED AND FANNED THEM INTO FLAME”.

RICHARD JEFFERIES



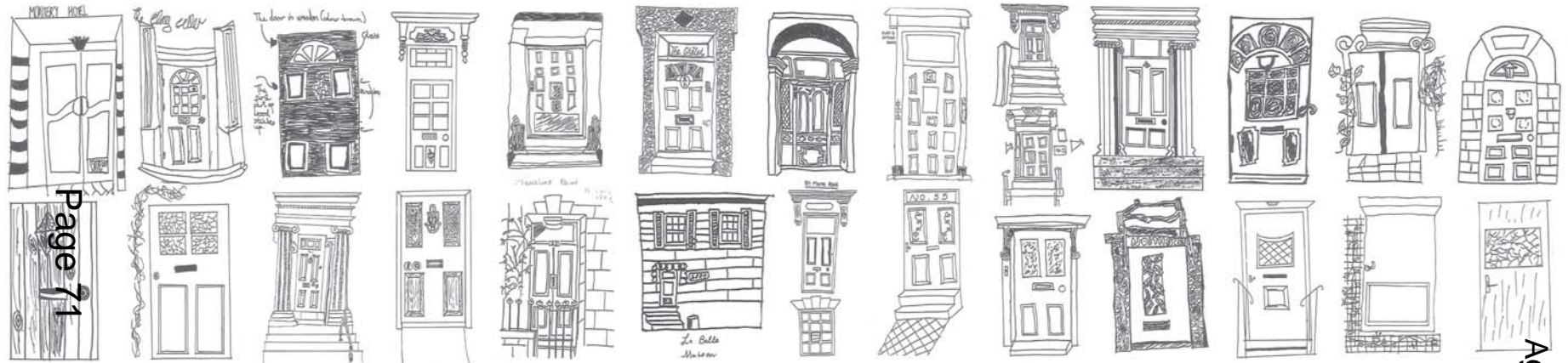

Page 71

Agenda Item 7

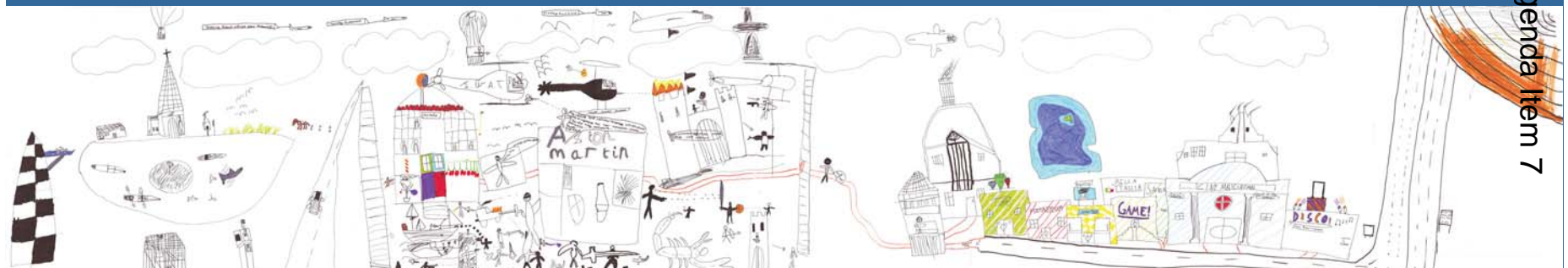



Page 72



Agenda Item 7



ENVIRONMENTAL EDUCATION, Jersey

What we have carried out with a number of our urban studies is a programme of Environmental Education based around the study of "The Front Door" - the entrance being the key to everything, the way in, the way through and the way out again, whether in a large house or a small town.

This study, conducted with 250 pupils from two primary schools and one secondary school in St Helier, Jersey, was part of an urban study of a 40 acre Environmental and Improvement Area in the city.

Carried out in collaboration with Delphine Geoghan, the work involved a series of Planning for Real workshops, a central feature of which were the studies prepared by the school pupils. The school work was planned with the teachers involved, as an integral part of the pupil's school curricular.

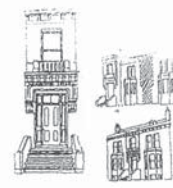
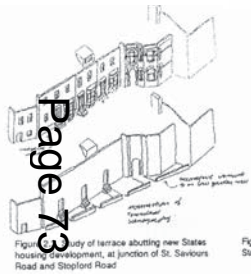
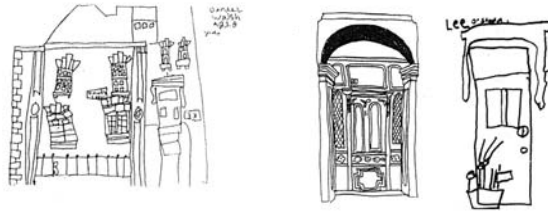

Agenda Item 7

THANK YOU FOR LISTENING

# Sevenoaks District Community Safety Partnership Annual Report 2016-17

Kelly Webb, Community Safety Manager



# Overview of Report

---

- The Annual Report looks at statistics and projects that the Community Safety Partnership have been involved with over the last financial year 1 April 2016 – 31 March 2017
- It addresses the work that the Partnership has done against the priorities identified from the Strategic Assessment

# Sevenoaks District Crime Statistics 2015/16 v 2016/17

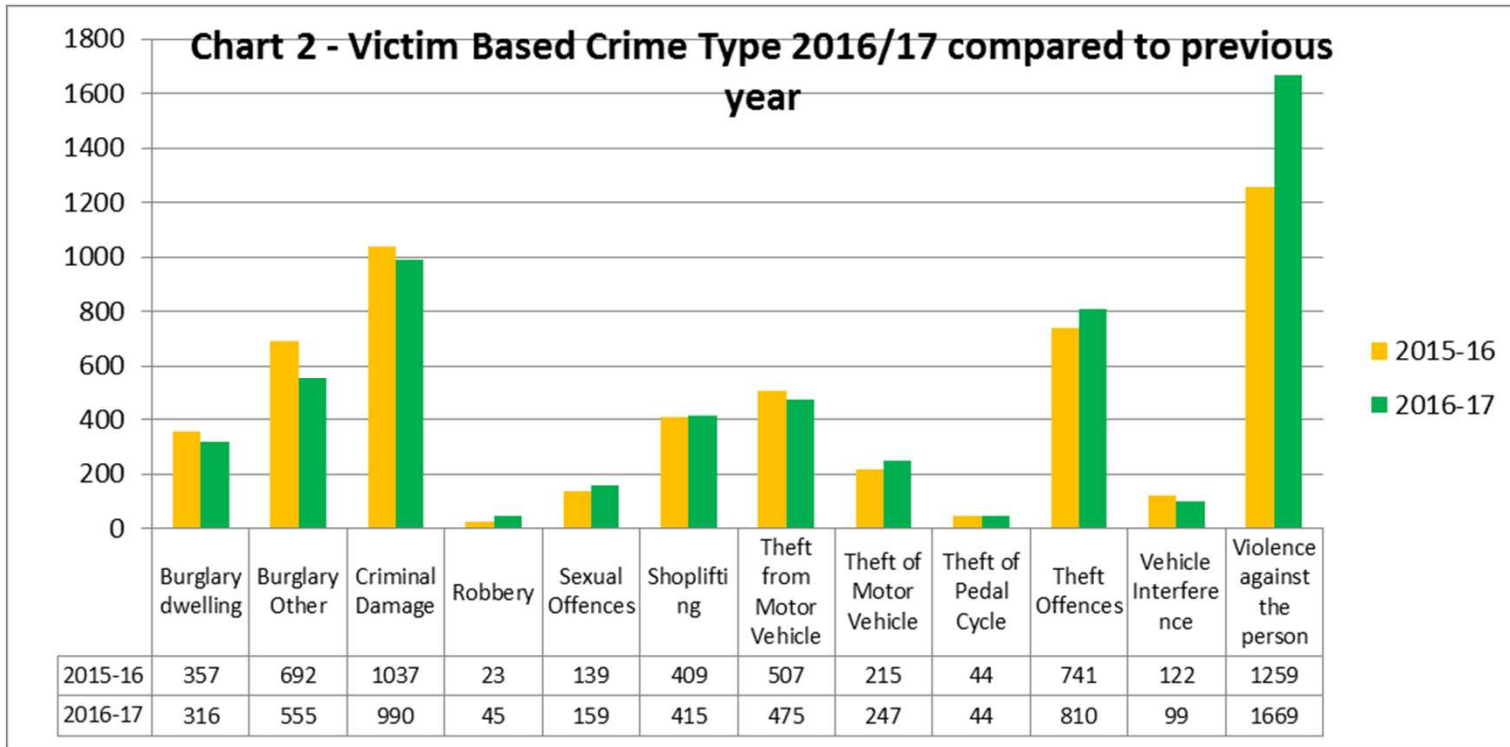

# ASB Incidents 2015/16 v 2016/17

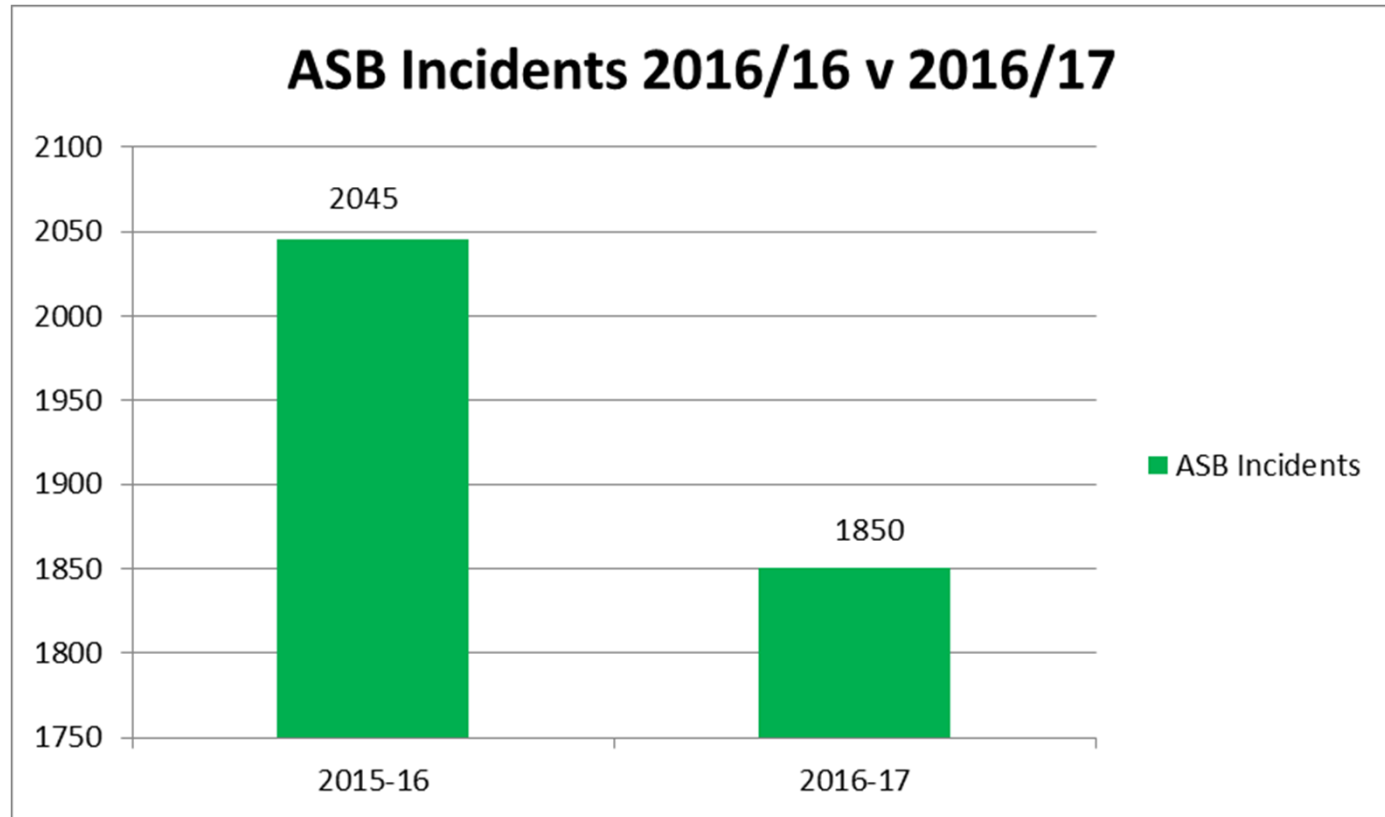



# Drug Offence Rolling Year 2015/16 compared to 2016/17

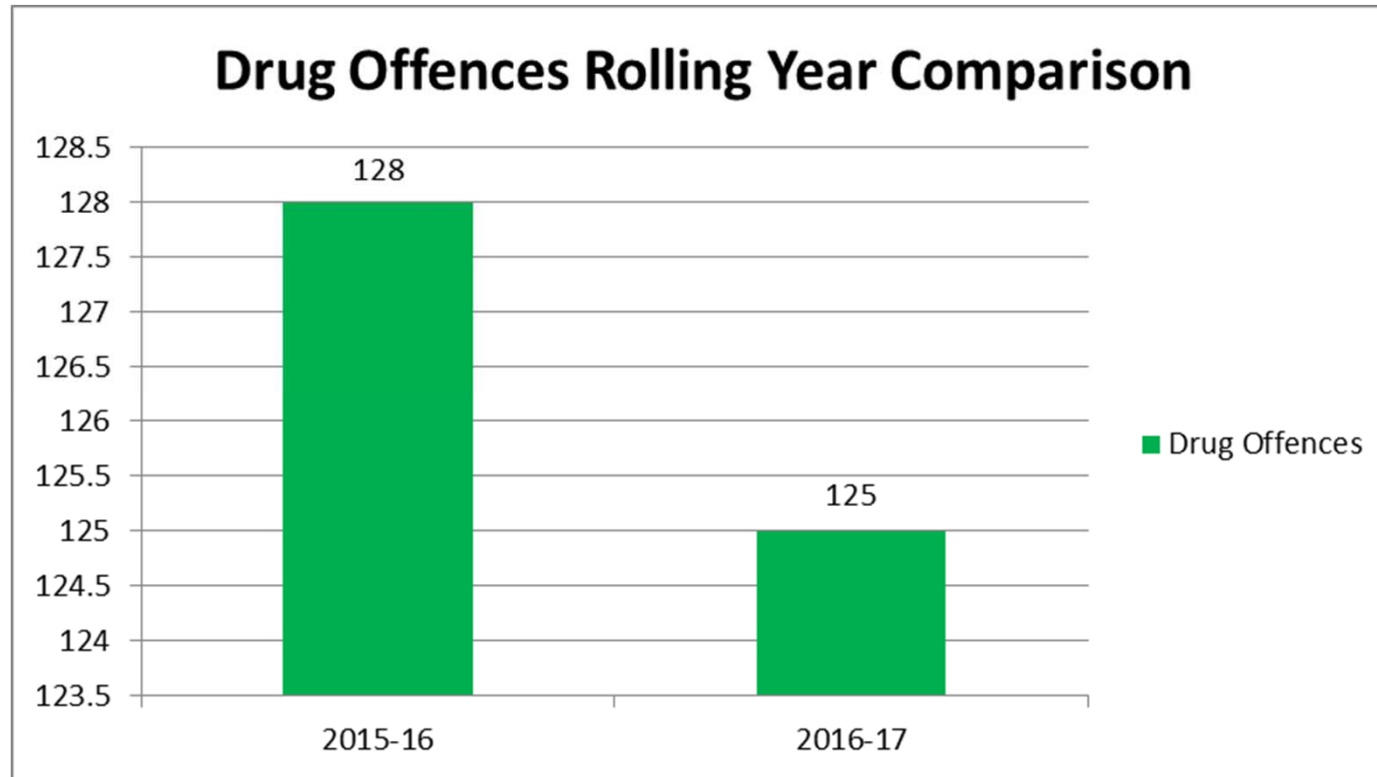

# CSU

---

- The CSU meets every morning to go through the previous 24hours ASB reports, Concern Calls and community safety issues from Police, SDC, Wardens, Housing Associations and other partners.
- 1 April 2016 – 31 March 2017 the CSU dealt with **710** reports with all informants being feedback on actions where possible.

# Work against CSP Priorities - ASB

---

- The SDC ASB Officer has worked on 93 reports of anti social behaviour from residents. This is an decrease of 70 calls compared to the same period last year.
- The Officer continues to chair the ASB Task Group monitoring and working with individuals identified as causing ASB across the District. This can involve working with approximately 15-20 people to offer support and take enforcement action where necessary.
- Task and Finish Groups have been established to provide intensive intervention by Partner Agencies for areas or vulnerable people when a number of reports have come in through the CSU Daily Tasking meetings. During 2016-17 there were 12 Task and Finish Groups set up of which 10 were completed and 4 are ongoing.



# Work against CSP Priorities - Safeguarding

---

- **Gang Training** was delivered in June 2016 to front line trainers delivered by RRR and Kent Police. Over 30 people attended the training.
- **Prevent Training** was delivered by Community Safety Team in October 2016 to new SDC Staff Members. This was delivered to over 60 members of staff.
- The Council are working on updating the Policy and this will be finalised in April 2017. This includes the authorities duties on Modern Slavery and Human Trafficking as well as FGM (Female Genital Mutilation)

**CSE (Child Sexual Exploitation) Training** was held in September to help workers identify signs and to put in safeguarding processes

# Work against CSP Priorities – Acquisitive Crime

---

- The Police have continued to run ‘Op Weymouth’ and ‘Op Cocoon’ The operation involves targeting both Burglary & Vehicle Crime. This involved specific offenders being targeted as well as offering advice and information to local residents and repeat and vulnerable victims. There were 43 Op Cocoon from 1 April 2016 - 31 March 2017.
- There have been 10 Safer Plates Events delivered by Police Community Support Officers across the District where tamper proof screws have been fitted, free of charge, to prevent the theft of number plates.
- A leaflet providing information on Vehicle Crime was produced and is available on the District Council website. It has also been delivered to areas where there has been a report of Vehicle Crime.

# Work against CSP Priorities – Young People

---

- 'Real Life' a play by Sevenoaks Youth Theatre about cyber bullying and sexting for teenagers was adapted for Years 5 and 6. All schools were invited to attend on 7 February to Stag Theatre to watch the play free of charge. There were 2 sessions. Each session was at capacity with over 800 pupils attending (16 schools). Meridian TV also covered the event.
- **West Kent Extra has been working** closely with younger people to reduce negative attitudes and behaviour by providing learning activities, crime prevention projects, a Buddy Scheme and Reflection Scheme. In December 2016 they were awarded a 5 year contract across the District to deliver youth work.
- **Reform Restore Respect (RRR)** is a District based charity which provides anti crime workshops to schools across the district and 1:1 work with individuals who need intensive advice and support. Between 1 April 2016 to 31 March 2017, 7 workshops were delivered in schools.

# Work against CSP Priorities – Road Safety

---

- 4 multi agency road operations have been held by the Police, KCC Community Wardens and Kent Fire Rescue Service across the District. Drivers who were caught speeding by the Police were given an educational package at the roadside by KFRS and Community Wardens instead of penalty points. Over 20 drivers per session were stopped and the majority took on the 30 minute educational session, others had penalty notices issued.
- **Speed Watch** volunteer sessions are now held on line by Kent Police. Speed Watch Groups are proactive in: Bayham Road, Sevenoaks; Noah's Ark; Chevening; Brittain's Lane, Sevenoaks; Edenbridge; Crockenhill; Westerham; Bessels Green and White Hart Estate, Sevenoaks.

# Work against CSP Priorities – Domestic Abuse

---

- 1 April 2016 - 31 March 2017 there was an increase of 109 crimes (8%) 1466 reports of Domestic Abuse including Secondary Incidents to Police Repeat victims rolling data have also seen an increase of 330 to 371 repeat victims.
- **Domestic Abuse Training** was held in July and September dealing with DASH & Young Peoples Dash (Domestic Abuse Stalking & Harassment) for front line workers. Around 50 people attended each event.
- .During the year, DAVSS supported 271 victims of domestic abuse (40 more than same period last year) in the Sevenoaks District. There were 111 calls to the helpline, a reduction of 90 calls compared to the same period last year.



# Work against CSP Priorities – Substance Misuse

---

- With PCC funding through the Partnership, Kenward Trust has worked with over 350 young people this financial year in addition to their work in schools. They have also been tasked to work in over 15 locations that have been highlighted by the CSU in response to community concerns over drugs and alcohol.
- **CRI**, commissioned by the Kent Drugs and Alcohol Service, provide **early intervention services**. This includes **breakfast clubs and specialist rehabilitation services**. They also undertake home visits to those with children and mobility issues.
- A Substance Misuse Conference was held in July 2016. The conference looked at Illegal/Legal Highs Approx. 40 front line workers attended. The Substance Misuse Task Group meets twice a year.

# Successes

---

- Shop Safe Stay Safe Launched in Edenbridge and Sevenoaks. This is a scheme aimed at helping local vulnerable people (with a main focus on people living with dementia) when they are out shopping or in restaurants/pubs who may have become unwell, confused or lost their companion.
- A multi-agency visit was held at the Former Convent of Mercy site and Kent Fire & Rescue Service (KFRS) where they issued an enforcement notice on the site for the fire alarm system to be installed properly
- The Sevenoaks Freedom Programme was very successful, with a male facilitator. The attendees stated that it was good to have a positive male role model, and sent a good message.

# Successes

---

- Sevenoaks District went from the 3<sup>rd</sup> lowest to 2<sup>nd</sup> lowest for recorded crime across the District and has the lowest recorded number of ASB incidents in Kent
- Kent Police started delivering training regarding the ASB Powers
- The Business Crime Reduction Partnership extended their members to 41 shops/businesses signing up to the scheme.
- Multi-Agency meeting was held in Westerham to discuss issues, names were put on the ASB task Group and Police have been doing high visibility Productive Policing in the area



# Successes

---

- Shop Safe Stay Safe Launched in Edenbridge and Sevenoaks. This is a scheme aimed at helping local vulnerable people (with a main focus on people living with dementia) when they are out shopping or in restaurants/pubs who may have become unwell, confused or lost their companion.
- A multi-agency visit was held at the Former Convent of Mercy site and Kent Fire & Rescue Service (KFRS) where they issued an enforcement notice on the site for the fire alarm system to be installed properly
- The Sevenoaks Freedom Programme was very successful, with a male facilitator. The attendees stated that it was good to have a positive male role model, and sent a good message.



# Thank you



This page is intentionally left blank

## What does Economic Development offer businesses ?



Business support  
4 hours free 121 advice



Real Business newsletter  
Free email information



Events  
Seminars, learning and networking



Meeting businesses  
attending events, networking, promoting services



Signposting to support  
working with partners to understand offers



Team Around Your Business  
help businesses to access Council Services

This page is intentionally left blank